

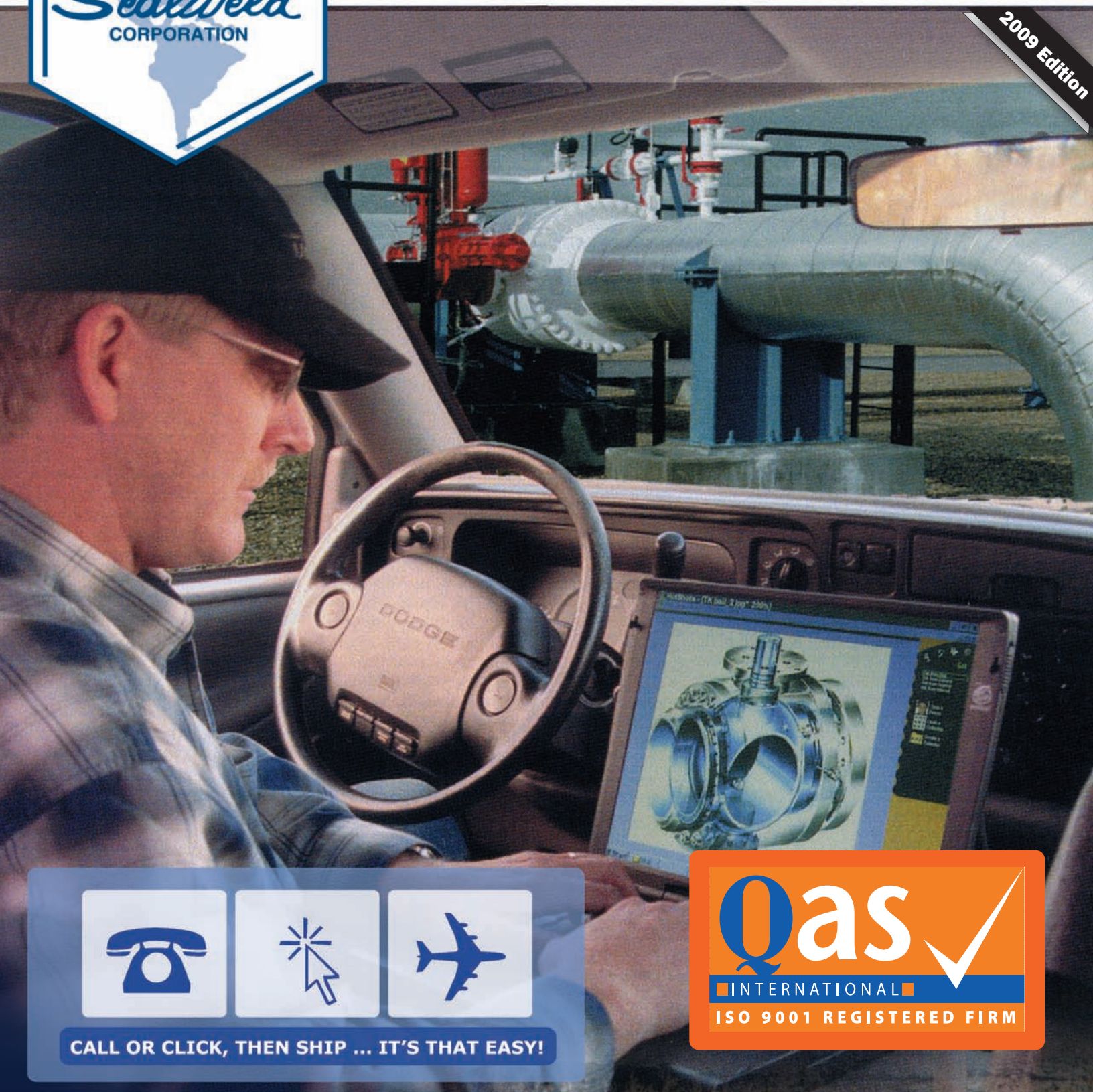

# Sealweld®

## VALVE INTEGRITY MADE EASY

2009 Edition



CALL OR CLICK, THEN SHIP ... IT'S THAT EASY!

**Qas** ✓  
INTERNATIONAL  
ISO 9001 REGISTERED FIRM

## Sealweld Valve Care Products Catalogue

### CALL TO ORDER 1-800-661-8465

## Table of Contents

Sealweld®, An Introduction . . . . .	1
Valve Maintenance & Service Hints. . . . .	2
Key Points for Safe Valve Maintenance . . . . .	2
Valve Lubricant/Sealant Capacity Chart . . . . .	6
Cleaners, Lubricants & Sealants . . . . .	7
SAGD . . . . .	13
Injectable & Moldable Packings . . . . .	14
Sealant Injection Equipment . . . . .	16
ACTIV-8®. . . . .	17
Uni-Seal™ . . . . .	20
SuperGun® . . . . .	22
Hydraulic Hand-Held. . . . .	24
Sealant Injection Fittings . . . . .	26
Adapters & Couplers . . . . .	40
Fittings . . . . .	44
Recommended Accessories . . . . .	46

## Sealweld® - Worldwide



We accept the following forms of payment  
Debit, VISA, MasterCard, American Express  
and Cash



ISO CERTIFIED 9001:2000 # A1339CAN





Sealweld® products have proven reliable in over 80 countries worldwide since 1969. Our focus is on the safe reduction and elimination of pipeline valve leakage. We offer all of the tools you'll need with a one-stop shopping convenience that is not available elsewhere. When you shop with Sealweld®, you get access to the know-how that saves pipeline operators millions in unnecessary shut-down costs.

*Always innovative, professional and dedicated, Sealweld®... valve integrity made easy.*

### Sealweld® Synthetic Valve Lubricants & Sealants

Are preferred by professional valve maintenance technicians around the world because they have come to depend on our consistent quality and performance in routine use and in an emergency when a critical seal is demanded.

Sealweld® Valve Care Products are recommended by many of the world's largest valve manufacturers and are recommended as "no substitute" by many of the world's largest pipeline operators and oil and gas companies for almost forty years.

Our easy 3-step process of injecting **Valve Cleaner Plus**, **Total-Lube #911** and Sealweld® **#5050** sealant will resolve over 80% of all normal valve leakage problems in natural gas, crude oil and related hydrocarbon product services.

Sealweld® synthetic valve lubricants are formulated to remain soft and pliable, and will not break-down or go hard in order to achieve the longest possible in-service maintenance cycle.

Sealweld® synthetic valve sealants are unique and have no equal. They are designed to provide a reliable, temporary seal even in severely leaking valves.



### Sealweld® High-Pressure Sealant Injection Guns & Pumps

Designed by professional valve technicians to be the most rugged and reliable high-pressure pumps in the world. Easy to repair and designed for many years of reliable service in all working conditions. Dependable performance, in the most demanding field conditions, is what makes Sealweld® pumping equipment so popular with field personnel.

### Sealweld® Sealant Injection Fittings & Adapters

The patented **Flow Wolf®** one-way check valve design has been incorporated into all of our fittings and adapters for increased technician safety and improved pipeline integrity. Extend the in-service life span of all your critical valves many times over by specifying "**Flow Wolf® – No Substitutes**" when ordering new valves and during outages when fittings can be safely replaced.

### ValvePro® – Valve Technician Certification Program

Learn all the basic procedures for servicing valves in-line and under pressure in a clearly defined step-by-step computer-based learning format. Designed by professional valve technicians with decades of experience. Ideal for new hires to learn the basics of preventative valve maintenance. Effective as a refresher program for experienced field personnel who need a quick solution to a valve emergency situation.

**ValvePro®** encompasses proven learning techniques including; computer and web-based learning, instructor-led lectures, workshops and task competency testing. **ValvePro®** students receive a Certificate of Completion. Can be complimented by instructor-led field training at your facility for advanced hands-on troubleshooting workshops.

Sealweld® is your single-source solution for all your valve maintenance needs. Dependable products with a long history of saving pipeline operators from unscheduled shut-downs and outages. Our training products are designed to empower your maintenance personnel to work more safely and achieve reliable, consistent results. Sealweld® works with a global network of ValvePro-certified, independent valve service providers available for short and long-term valve maintenance service contracts and are specialized in a broad range of valve specialist services.

Dean Chisholm, Managing Director, Sealweld® Corporation



## KEY POINTS FOR SAFE VALVE MAINTENANCE

Effective valve maintenance can be accomplished using cleaners and introducing the proper lubricant at regular and frequent intervals. This will assure efficient and safe operation of thousands of valves that are now being removed and repaired or discarded each year.

It has been suggested that increasing the frequency of servicing valves automatically places more grease into pipelines and other facilities. Not so. Injection of small amounts of our high-quality, insoluble lubricants will provide proper lubrication of valves at all times, and, ultimately, require less lubricant.

Cleaning and lubricating a valve, like changing oil in a new car, is a **MUST** if economical operation and long life are expected.

**ALWAYS** get specific authorization from your supervisor or the control room **BEFORE** cycling (turning or operating) any valve in the system.

Do **NOT** open the body vent/drain fitting in the body cavity unless it is safe to do so.

Most gases are lethal in high concentrations. Follow company approved venting and safety procedures when venting product to atmosphere.

Many types of hydrocarbon liquids and gases can explode violently in certain mixtures and concentrations.

Take your time when servicing valves, be patient. The problems have taken many years to develop, it may take a few hours or even days to get some of the more difficult valves working properly again.

**NEVER** use excessive force or torque when trying to turn a seized valve. Excess stem torque may cause the valve stem to bend or break making the valve inoperable.

**ALWAYS** keep the high-pressure gauge on the sealant injection pump working properly.

Most hand-held sealant injection pumps are capable of generating 10,000 to 15,000 PSI. Learn to 'read' the high-pressure gauge attached to the pump.

Read the original maintenance manual supplied with the valve for specific details regarding safe valve maintenance routines.

Watch the needle on the gauge drop as sealant moves into the valve. If blockage occurs the needle will not drop. Stop pumping and inject Sealweld® Valve Cleaner Plus to open the passage.

## Cleaning Valves

Valves which hang up, are hard-to-turn or do not seal properly usually require cleaning. Inject sufficient quantities of cleaner to displace all of the lubricant/ sealant in the valve sealant system\*. Leave the valve cleaner in the valve for at least 30 to 40 minutes and cycle the valve, if permitted, to ensure complete coverage. **ALWAYS** displace the valve cleaner with equal quantities of lubricant/ sealant after cleaning. For problem valves, leave the cleaner inside the valve for several days and top-up frequently. Tests prove that periodic lubrication with valve cleaner prevents formation of gums and lacquers in valves, preventing costly repairs and down-time. \* Consult the "Valve Lubricant/ Sealant Capacity Chart" on page 6.

Valve cleaner is used as an internal valve cleaning compound in ball, gate and plug valves, as well as orifice fittings. Use in wellhead valves, at pump and compressor stations and distribution systems. Ideal for use on valves with plugged sealant fittings, seat leakage problems or valves which are hard-to-turn. The best results are achieved by injecting while the valve is in the full open or full closed position. Purge valve cleaner from the system after use.

**ALWAYS** attach a **Flow Wolf® Leak-Lock Adapter** to the valve fitting prior to injecting valve cleaners.

## Topping-Up Lubricant/ Sealant

Routine maintenance often consists of topping-up the lubricant/ sealant in the valve sealant system.\* The sealant system is a network of grooves and channels inside the valve leading to seal points around the ball, gate or plug. Quantities required to top-up any valve can vary greatly depending on the valve size, design, cycle frequency, service conditions and riser pipe height, if applicable. Use correct volumes of grease, too much and the excess is washed downstream, too little is a waste of time, money and manpower. Learn how to properly 'read' a high-pressure sealant injection gauge (mounted on the pump) to help determine when the sealant reaches the seal points.

\* Consult the "Sealweld® Service Procedures Library" on page 47 for Technical Papers and Training Materials..



## Lubricants

Sealweld® lubricants are a grease-like substance designed to lower torque in valves, is resistant to deterioration by product flowing through the pipeline and is stable over a broad temperature range.

\* Consult the "Cleaners, Lubricants & Sealants" section on pages 6 - 13.

## Lubricant/ Sealants

Lubricant/ sealants are similar in characteristics to valve lubricants, with added bridging agents to provide sealing ability for minor damage such as scratches on seal faces.

## Emergency Sealants

The introduction of heavy sealants provides the ability to achieve a temporary seal even if more serious seal damage has occurred. ALWAYS displace extra heavy sealant and double extra heavy sealant with a lighter lubricant/ sealant when the seal is no longer required to avoid the risk of plugging complications at some future date. Valves which constantly require extra heavy sealant should be adjusted, repaired or replaced.



## Packings

Sealweld® also manufactures a complete product line of semi-liquid and injectable packing compounds for valve stems, pump glands and stuffing boxes. Our packings are designed to lubricate and seal and extend seal life many times over. Our newest product, Sealweld® **Steam Shield Sticks** valve stem packing is performing exceptionally well in temperatures up to + 370°C (+ 700°F) and beyond.

For safety reasons, the removal of stem packing should NOT be attempted while the valve is under pressure.

## Injection Techniques

The best results are achieved by injecting while the valve is in the fully open or fully closed position. When attempting to seal a valve, if leakage persists, check the valve stops to ensure the valve is fully closed.

## Lubricant Fittings

Many lubricant fittings have a two-piece body construction. Some valve manufacturers install this type at the factory. Usually reliable, the fitting pieces have been known to separate under pressure causing serious injury or fatality. Safer fittings reduce the pipeline operators' risk of liability.

Due to the absence of industry standards many dangerous types of fittings have been put into service. Fitting failure is the #1 cause of technician injury and/ or death.

Sealweld® Corporation has invested many years of research and development into designing the **Flow Wolf®** and have obtained Alberta Boilers Branch approval for our **Flow Wolf®** Internal Check Valves, **Flow Wolf®** Sealant Injection Fittings, and Sealweld® Body Vent Fittings. Certified fittings are stamped with a Canadian Registration Number (CRN)\*.

\* European CE marking and API approvals are pending

### CAUTION

ALWAYS consult the valve manufacturers service manual BEFORE attempting any service procedure.

## Commissioning New Valves

Most valve seal damage occurs during construction and commissioning because this is when the most foreign debris is in the system. Sealweld® has developed simple and proven effective procedures for eliminating the most common reasons for seal damage. These procedures are proven cost-effective and can add many years to the service life of all types and brands of valves.

**New Valve Commissioning** has been included in the **ValvePro®** - Valve Technician Certification program. Call Sealweld® for more information.

All of our technical papers are available on our web site at [www.sealweld.com](http://www.sealweld.com)



*Follow these simple procedures to prevent the loss of production, reduce down-time and costly repairs.*

*For procedures for the safe, in-line servicing of valves under pressure, we recommend ValvePro®, the Certified Valve Maintenance Technician Training Program.*

*For more information and to register, go to: [www.valvepro.com](http://www.valvepro.com)*

## Ball Valves

### VALVE SEAT LEAKS

Inject Sealweld® **Valve Cleaner Plus** then cycle the valve 3 times (if permitted). Wait 30 to 40 minutes and cycle valve again. If there is no physical damage to the seals this will be all that is required. The cleaning procedure will remove the build-up of contaminants from seal faces, allowing the seat rings to sit down tightly on the ball. Purge the cleaner by injecting an equal amount of lubricant or sealant. In new valves or valves with no seat damage inject **Equa-Lube Eighty**. If the seat leakage rate is minor, inject **Total-Lube #911**. In cases of severe seat leakage, inject Sealweld® **Ball Valve Sealant #5050**.

### VALVE STEM LEAKS

If the valve is equipped with a buttonhead sealant injection fitting in the stem seal area, inject Sealweld® **Ball Valve Sealant #5050**. DO NOT exceed 3,000 PSI injection pressure. Refer to the Valve Maintenance and Servicing Hints available from Sealweld® and follow these simple procedures to help reduce the loss of product, down-time and costly repairs.

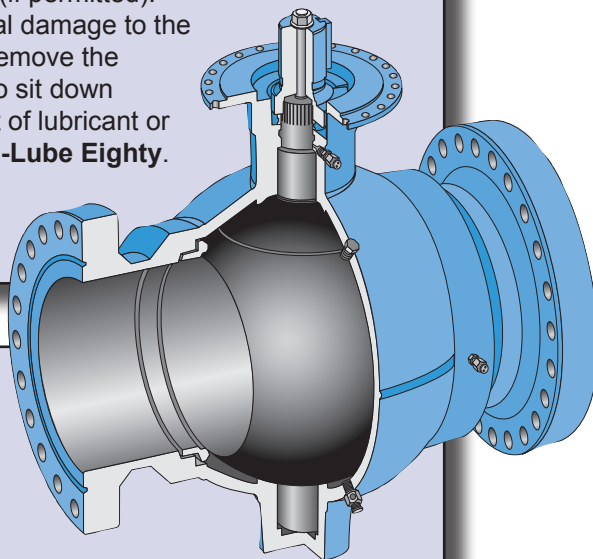

All of the Sealweld® compounds referred to may be injected using Sealweld® Sealant Injection Equipment or any other type of high-pressure manual or pneumatic injection pump. DO NOT use low-pressure automotive pumps. See the Sealweld® Injection Equipment section for additional information.





## Gate Valves

### VALVE SEAT LEAKS

When injecting directly into the body cavity, the injection pressure should NEVER exceed the maximum rated working pressure (MWP) of the valve. Inject Sealweld® **Valve Cleaner Plus**, allow the cleaner to soak for 30 - 40 minutes, up to 24 hours. Cycle the valve 3 times to spread the cleaner. Follow up by injecting **Total-Lube #911** and cycle the valve repeatedly.

### VALVE STEM LEAKS

If equipped with a packing injector, inject Sealweld® **Slick Sticks**.

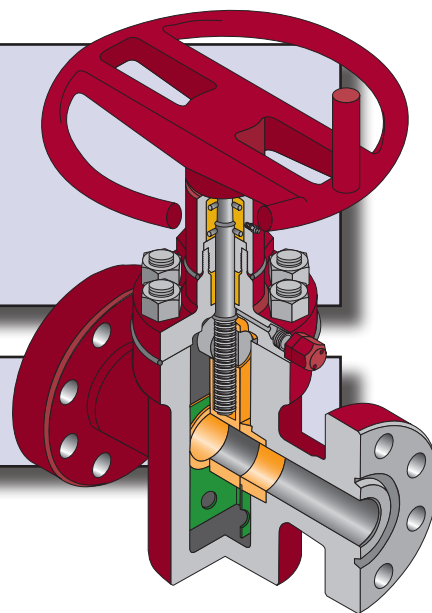

## Plug Valves

### SEIZED OR HARD-TO-TURN

Calculate the quantity required\*, then fill with **Valve Cleaner Plus**. Wait 30 minutes, cycle the valve repeatedly, then inject the same quantity of **Total-Lube #911**.

\* Consult the "Valve Lubricant/ Sealant Capacity Chart" on page 13.

### STEM PACKING LEAKS OR VALVE IS STILL HARD-TO-TURN

For plug valves equipped with stem packing such as threaded-stem plug valves -- use the following procedure. Be sure pressure is relieved from valve, remove plug from opposite side of stem packing injector, dig out old packing, fill cavity with **Valve Cleaner Plus** to soften and break-down any old, dried, hardened stem packing. Replace plug. Load the stem packing injector with Sealweld® **Slick Sticks** and repack valve stem by turning bolt in until it is tight. This may take several sticks. If the plug valve stem is leaking but the valve turns easily - simply load the packing injector with **Slick Sticks** to repack.

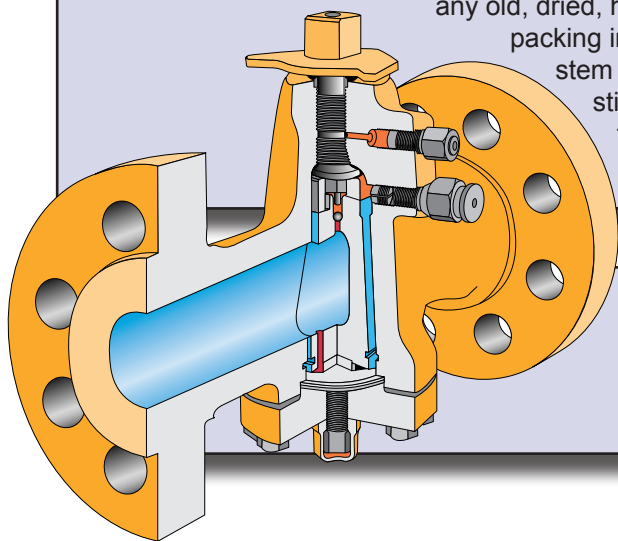

### VALVE LEAKS IN CLOSED POSITION

After cleaning with **Valve Cleaner Plus**, inject Sealweld® **Total-Lube #911** Lubricant/ Sealant.



## Valve Lubricant/ Sealant Capacity Chart

### BALL VALVES

Inject approximately 1 ounce of lubricant/ sealant per inch of valve size into each seat ring.

*Example:* 10" ball valve x 2 seat rings = 20 ounces lubricant/ sealant

### GATE VALVES

Pipeline gate valves with seat sealant systems require approximately 0.5 ounces of lubricant/ sealant per inch of valve size into each seat ring.

*Example:* 4" gate valve x 2 seat rings = 4 ounces lubricant/ sealant

### Wellhead Gate Valves

To fill the body cavity of a gate valve, inject approximately 16 ounces per inch of valve size.

*Example:* 4" gate valve x 16 ounces = 64 ounces lubricant/ sealant

### PLUG VALVES

4" & smaller: 1 ounce/ inch size

*Example:* 4" plug valve x 1 ounce = 4 ounces lubricant/ sealant

6" to 14": 1.5 ounces/ inch size

*Example:* 10" plug valve x 1.5 ounces = 15 ounces lubricant/ sealant

14" to 18": 2.5 ounces/ inch size

*Example:* 16" plug valve x 2.5 ounces = 40 ounces lubricant/ sealant

18" & larger: 3.5 ounces/ inch size

*Example:* 24" plug valve x 3.5 ounces = 84 ounces lubricant/ sealant

Contact Sealweld® for valve capacity calculation tables.

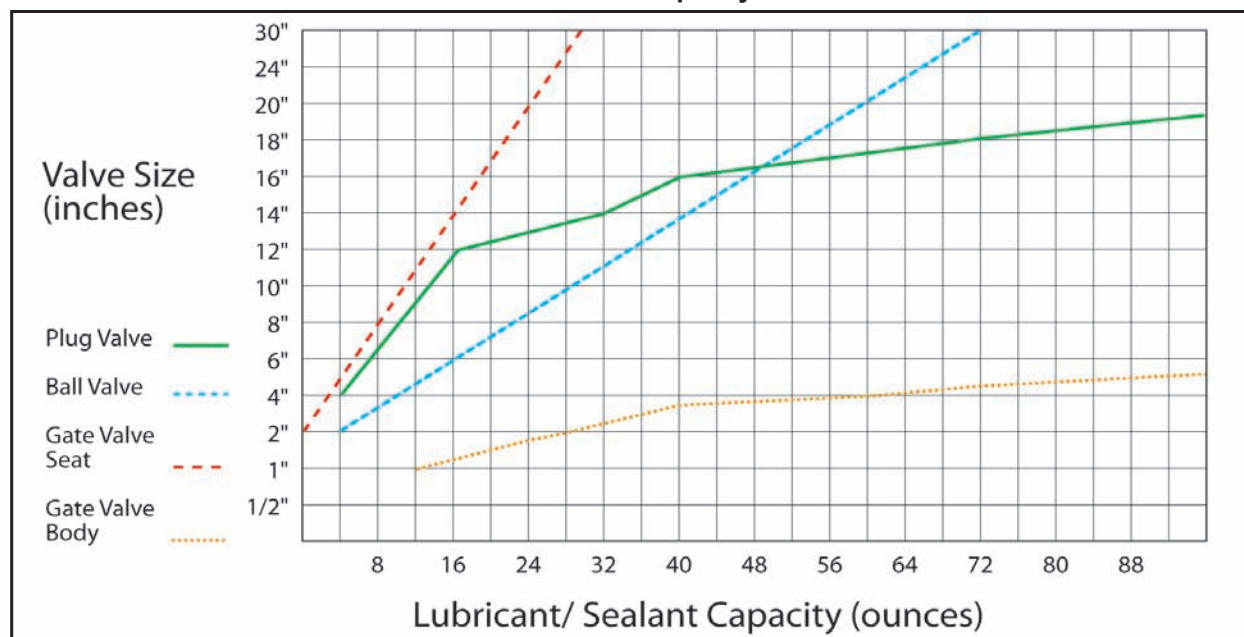

### SEALANT CAPACITY FOR HOSES & RISER PIPES

Use the following calculation to determine how much lubricant/ sealant you need to get the job done right, the first time!

**Valve capacity + Hose capacity + Riser Pipe capacity = Total Quantity Required**

1/4" inside diameter hose requires approximately 0.5 ounces per foot \*

*Example:* 1/4" ID x 18" sealant hose = 1.5 foot sealant hose x 0.5 ounces = 0.75 ounces hose capacity

3/8" inside diameter hose requires approximately 1.3 ounces per foot

*Example:* 3/8" ID x 60" sealant hose = 5 foot sealant hose x 1.3 ounces = 6.5 ounces hose capacity

1/2" inside diameter hose requires approximately 2 ounces per foot

*Example:* 1/2" ID x 160" sealant hose = 10 foot sealant hose x 2 ounces = 20 ounces hose capacity

\* One foot equals 12 inches.

*Example:* 1/2" ID x 8 foot\* risers x 2.0 ounces x 2 riser pipes = 32 ounces riser pipe capacity

3/4" inside diameter hose requires approximately 4 ounces per foot

*Example:* 3/4" ID x 160" sealant hose = 10 foot sealant hose x 4 ounces = 40 ounces





## Valve Cleaner Plus

Non-hazardous, environmentally friendly product designed to clean important valve seal faces and sealant passages.

### DESCRIPTION

**Valve Cleaner Plus** is not a sealant, it is a combination of solvent and semi-synthetic lubrication oils. Formulated to be injected directly into the seat sealant system to clean important seal faces and sealant passages. Cycle the valve (if permitted) to ensure complete coverage, to allow the valve cleaner to soften old sealants and remove residual build-up from seal points. Valves with severe or persistent leakage may require more wait time. The best results are achieved by displacing the valve cleaner with equal quantities of lubricant/ sealant after cleaning. Recommended for use in ball, gate or plug valves and orifice fittings. For use at refineries, wellheads, pump or compressor stations and in gas distribution systems.

Non-Flammable  
Non-Carcinogenic  
Non-Ozone Depleting

### Product Specifications

Base Oil	Semi-synthetic
Colour	Black
Drop Point	+ 235°C or + 455°F
Texture	Thin paste
Pressure	10,000 PSI
ASTM Penetration	270 - 330
Compatibility	Dispersant
Solvent Resistance	N/A
Special Additives	Molybdenum Disulfide
Composition	Semi-liquid
Temperature Range	- 40°C to + 204°C - 40°F to + 400°F

### Order Details

10 Ounce Cartridge - 1 Single	S-VCP-HG
14 Ounce Cartridge - 1 Single	S-VCP-SG
10 Ounce Cartridges - 16 per Case	S-VCP-HGC
14 Ounce Cartridges - 12 per Case	S-VCP-SGC
9 Pound Can	S-VCP-9P
36 Pound Pail	S-VCP-36P
110 Pound Drum	S-VCP-110D
360 Pound Drum	S-VCP-360D

## Odyssey Industrial Cleaning Solvent

A synthetic industrial cleaning solvent.

### DESCRIPTION

Sealweld® **Odyssey Cleaning Solvent** is a synthetic industrial cleaning solvent. Excellent for removing heavy deposits of grease, lubes and heavy oils, as well as removing sludge and dirt from metal parts. Sealweld® **Odyssey Cleaning Solvent** will not harm metal, most types of rubber, plastic or concrete. It is excellent for dissolving asphaltene build-up, and has many other uses in the industrial marketplace. Sealweld® **Odyssey Cleaning Solvent** does not contain water and is not water-soluble, on the contrary it leaves behind a protective barrier that inhibits spot rust. This non-flammable, non-hazardous, and non-polluting solvent is as safe for the person using it as it is for the environment.

Non-Flammable  
Non-Hazardous  
Non-Polluting

### Product Specifications

Temperature Range	- 29°C to + 232°C - 20°F to + 450°F
-------------------	--

### Order Details

Ordering Size	Part No.
Spray Bottle	K-OS-SB
Bottle - 4 Liters	K-OS-4L
Pail - 5 Gallons	K-OS-5G
Drum - 45 Gallons	K-OS-45G

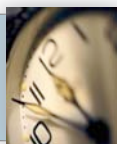

**Be patient! Let valve cleaner soak overnight if necessary.**

\* Consult the Shipping Weights & Dimensions table on page 15



## Equa-Lube Eighty

Our most economical, light synthetic lubricant ideal for commissioning new pipeline valves. Use in ball, gate and plug valves with little to no wear, as well as orifice fittings.

Ideal for year-round use and in all climates.

### DESCRIPTION

Sealweld® **Equa-Lube Eighty** provides an insoluble film of lubricant to protect critical seal faces and reduce torque requirements. Extend valve service life by injecting Sealweld® **Equa-Lube Eighty** immediately after the hydrostatic test at the valve factory or repair facility. This will purge all test water from the seat pockets where corrosion commonly occurs. Protects against damage from pipeline contaminants, such as dirt, sand, line scale and welding slag at start-up. Insoluble in water, crude oil, natural gas, condensate and related by-products.

Recommended for use in new valves, wellhead valves, at refineries, pump and compressor stations and in gas distribution systems.

Product Specification	
Base Oil	Synthetic
Colour	Amber/ Brown
Drop Point	None
Texture	Tacky
Pressure	10,000 PSI
ASTM Penetration	220 - 280
Compatibility	Excellent
Solvent Resistance	Excellent
Special Additives	None
Particle Size	N/A
Composition	Semi-liquid
Temperature Range	- 40°C to + 149°C - 40°F to + 300°F

Order Details	
Ordering Size	Part No.
'J' Stick - 1-3/8" x 8-1/2" - 1 Stick	S-EQ-J
'J' Stick - 1-3/8" x 8-1/2" - 16/Box	S-EQ-16J
11 Ounce Cartridge - 1 Single	S-EQ-HG
15 Ounce Cartridge - 1 Single	S-EQ-SG
11 Ounce Cartridges - 16/Case	S-EQ-HGC
15 Ounce Cartridges - 12/Case	S-EQ-SGC
10 Pound Can	S-EQ-10P
40 Pound Pail	S-EQ-40P
120 Pound Drum	S-EQ-120D
16 Ounce Brush Top Can	S-EQ-BT
16 Ounce Brush Top Can - 12/Case	S-EQ-BTC
400 Pound Drum	S-EQ-400D

## Total-Lube #911

Superior grade synthetic lubricant/ sealant designed specifically for worn valves with minor leakage problems.

### DESCRIPTION

Sealweld® **Total-Lube #911** provides an insoluble film of lubricant to protect seal faces and reduce torque requirements. Microscopic particles of PTFE will seal minor scratches to sealing surfaces and shallow corrosion pits. Seals scratches up to 0.010" and nicks and cuts on soft seats. Designed specifically as an all-purpose seat lubricant/ sealant to extend the maintenance interval in severe service and critical service valves. Sealweld® **Total-Lube #911** is insoluble in water, oil, natural gas and related by-products.

Recommended for use in ball, gate, and plug valves as well as orifice fittings. Use at refineries, wellheads, pump or compressor stations and in gas distribution systems.

Product Specification	
Base Oil	Synthetic
Colour	White
Drop Point	None
Texture	Tacky
Pressure	10,000 PSI
ASTM Penetration	160 - 220
Compatibility	Excellent
Solvent Resistance	Excellent
Special Additives	PTFE
Particle Size	Micronized
Composition	Semi-liquid
Temperature Range	- 29°C to + 232°C - 20°F to + 450°F

Order Details	
Ordering Size	Part No.
'A' Stick - 1/4" x 1" - 108/Box	S-TL-108A
'B' Stick - 3/8" x 1-1/2" - 72/Box	S-TL-72B
'C' Stick - 7/16" x 2-1/8" - 32/Box	S-TL-32C
'D' Stick - 1/2" x 2-1/4" - 28/Box	S-TL-28D
'G' Stick - 5/8" x 3-1/2" - 14/Box	S-TL-14G
'J' Stick - 1-3/8" x 8-1/2" - 1 Stick	S-TL-J
'J' Stick - 1-3/8" x 8-1/2" - 6/Box	S-TL-6J
'J' Stick - 1-3/8" x 8-1/2" - 16/Box	S-TL-16J
11 Ounce Cartridge - 1 Single	S-TL-HG
15 Ounce Cartridge - 1 Single	S-TL-SG
11 Ounce Cartridges - 16/Case	S-TL-HGC
15 Ounce Cartridges - 12/Case	S-TL-SGC
10 Pound Can	S-TL-10P
40 Pound Pail	S-TL-40P
120 Pound Drum	S-TL-120D
400 Pound Drum	S-TL-400D



## Ball Valve Sealant #5050

A synthetic sealant recommended for use in pipeline valves with more severe leakage problems.

### DESCRIPTION

Sealweld® **Ball Valve Sealant #5050** provides an insoluble film of lubricant to protect seal faces and reduce torque requirements. Specially processed particles of PTFE will seal scratches to sealing surfaces up to 0.030". Will not harden or plug off conventional giant buttonhead sealant injection fittings. **#5050** is ideal for use in natural gas, water, oil, and related by-products. Use in ball, gate and plug valves, orifice fittings, valve stems and seat seals with minor to severe leakage problems. Use at refineries, wellheads, pump or compressor stations and in gas distribution systems. Suitable for crude oil, sour gas, CO<sub>2</sub>, water/ brine solutions, and refined petroleum product pipelines.

For best results, first inject Sealweld® **Valve Cleaner Plus**, then leave in the valve for 30 - 40 minutes (up to 8 hours for problem valves). Purge the system with Sealweld® **Total-Lube #911**. Inject **Ball Valve Sealant #5050** if **Total-Lube #911** fails to hold a reliable seal.

**#5050** is also available in heavier grades for severely leaking valves and emergency valve sealing conditions.

This product is available in a wide range of extra heavy grades with increasing amounts of PTFE. Designed for use by qualified technicians ONLY. Contact Sealweld® for consultation prior to application of these products.

Product Specification	
Base Oil	Synthetic
Colour	Green
Drop Point	None
Texture	Tacky
Pressure	10,000 PSI
ASTM Penetration	210 - 240
Compatibility	Excellent
Solvent Resistance	Excellent
Special Additives	PTFE
Particle Size	Micronized
Composition	Semi-liquid
Temperature Range	- 29°C to + 232°C
	- 20°F to + 450°F

Order Details	
Ordering Size	Part No.
11 Ounce Cartridge - 1 Single	S-VS-HG
15 Ounce Cartridge - 1 Single	S-VS-SG
11 Ounce Cartridges - 16/Case	S-VS-HGC
15 Ounce Cartridges - 12/Case	S-VS-SGC
10 Pound Can	S-VS-10P
40 Pound Pail	S-VS-40P
120 Pound Drum	S-VS-120D
400 Pound Drum	S-VS-400D

## Extra Heavy Ball Valve Sealant #5050

Synthetic emergency sealant for ball and gate valves with SEVERE leakage problems and pipeline valve stems in high-temperature service.

### DESCRIPTION

Designed for use by qualified technicians ONLY. Contact Sealweld® for consultation prior to application of these products.

Not recommended for use in plug valves except in an emergency. The excellent sealing ability of this compound may restrict internal sealant passages and/ or plug them completely. Purge from system after use. Not recommended for use in small diameter plug valves.

Order Details - XH #5050	
Ordering Size	Part No.
11 Ounce Cartridge - 1 Single	S-XS-HG
15 Ounce Cartridge - 1 Single	S-XS-SG
11 Ounce Cartridges - 16/Case	S-XS-HGC
15 Ounce Cartridges - 12/Case	S-XS-SGC
120 Pound Drum	S-XS-120D
10 Pound Can	S-XS-10P
40 Pound Pail	S-XS-40P
400 Pound Drum	S-XS-400D

Order Details - XXH #5050	
11 Ounce Cartridge - 1 Single	S-XXS-HG
15 Ounce Cartridge - 1 Single	S-XXS-SG
11 Ounce Cartridges - 16/Case	S-XXS-HGC
15 Ounce Cartridges - 12/Case	S-XXS-SGC
120 Pound Drum	S-XXS-120D
10 Pound Can	S-XXS-10P
40 Pound Pail	S-XXS-40P
400 Pound Drum	S-XXS-400D

Order Details - XXXH #5050	
11 Ounce Cartridge - 1 Single	S-XXXS-HG
15 Ounce Cartridge - 1 Single	S-XXXS-SG
11 Ounce Cartridges - 16/Case	S-XXXS-HGC
15 Ounce Cartridges - 12/Case	S-XXXS-SGC
120 Pound Drum	S-XXXS-120D
10 Pound Can	S-XXXS-10P
40 Pound Pail	S-XXXS-40P
400 Pound Drum	S-XXXS-400D

Order Details - XXXXH #5050	
11 Ounce Cartridge - 1 Single	S-XXXXS-HG
15 Ounce Cartridge - 1 Single	S-XXXXS-SG
11 Ounce Cartridges - 16/Case	S-XXXXS-HGC
15 Ounce Cartridges - 12/Case	S-XXXXS-SGC
120 Pound Drum	S-XXXXS-120D
10 Pound Can	S-XXXXS-10P
40 Pound Pail	S-XXXXS-40P
400 Pound Drum	S-XXXXS-400D





## Winter-Lube #7030

All-purpose synthetic valve lubricant formulated to remain soft in sub-zero winter climates.

### DESCRIPTION

Sealweld® **Winter-Lube #7030** is a synthetic-based lubricant designed specifically for use in sub-zero winter climates where conventional sealants become stiff and too hard to pump. Unique additives provide excellent low-temperature pumping ability and lower operating torque in severe operating conditions. Sealweld® **Winter-Lube #7030** can be used year-round in all types of service. Formulated to remain insoluble in water, oil, all types of hydrocarbon services including natural gas, condensate, related by-products, crude oil and refined petroleum products. Use in ball, gate and plug valves. Recommended for use on: above ground valves such as blow-down valves, pig launching and receiving valves and in refineries, wellheads, pump or compressor stations and in gas distribution systems.

Product Specification	
Base Oil	Synthetic
Colour	Grey
Drop Point	None
Texture	Tacky
Pressure	10,000 PSI
ASTM Penetration	220 - 280
Compatibility	Excellent
Solvent Resistance	Excellent
Special Additives	PTFE
Particle Size	Micronized
Temperature Range	- 40°C to + 205°C - 40°F to + 400°F

Order Details	
Ordering Size	Part No.
11 Ounce Cartridge - 1 Single	S-WL-HG
15 Ounce Cartridge - 1 Single	S-WL-SG
11 Ounce Cartridges - 16/Case	S-WL-HGC
15 Ounce Cartridges - 12/Case	S-WL-SGC
10 Pound Can	S-WL-10P
40 Pound Pail	S-WL-40P
120 Pound Drum	S-WL-120D
400 Pound Drum	S-WL-400D



## Winter-Seal #2525

Synthetic valve sealant for use in extremely cold climates.

**Winter-Seal #2525** is similar to our **#5050** sealant in terms of sealing ability and remains pumpable at cold temperatures.

### DESCRIPTION

Sealweld® **Winter-Seal #2525** utilizes the same base formula as Sealweld® **Winter-Lube #7030** with added PTFE particles that improve the sealing characteristics.

Sealweld® **Winter-Seal #2525** reduces torque and provides reliable sealing in leak passages up to 0.030". This product may also be used as a secondary stem sealant, when the ambient temperature makes pumping conventional sealants difficult and time consuming. Designed to remain insoluble in all types of hydrocarbon services including natural gas, condensate, related by-products, crude oil and refined petroleum products.

Product Specifications	
Base Oil	Synthetic
Colour	Dark Grey
Drop Point	None
Texture	Tacky
Pressure	10,000 PSI
ASTM Penetration	220 - 280
Compatibility	Excellent
Solvent Resistance	Excellent
Special Additives	PTFE
Particle Size	Micronized
Temperature Range	- 40°C to + 205°C - 40°F to + 400°F

Order Details	
Ordering Size	Part No.
11 Ounce Cartridge - 1 Single	S-WS-HG
15 Ounce Cartridge - 1 Single	S-WS-SG
11 Ounce Cartridges - 16 per Case	S-WS-HGC
15 Ounce Cartridges - 12 per Case	S-WS-SGC
10 Pound Can	S-WS-10P
40 Pound Pail	S-WS-40P
120 Pound Drum	S-WS-120D
400 Pound Drum	S-WS-400D

Order Details - XH / XXH	
Ordering Size	Part No.
10 Pound Can - Extra Heavy	S-WSX-10P
10 Pound Can - Extra Extra Heavy	S-WSXX-10P



We sell valve care products.  
We deliver peace of mind.



## Low-Temperature Lubricant D-1014

Synthetic valve lubricant, extremely light consistency, designed for super-cold LNG/ LPG and similar applications. **D-1014** is available with or without PTFE and in extra heavy grade S-XD.

### DESCRIPTION

Sealweld® **Low-Temperature Lubricant D-1014** is a proprietary blend of synthetic materials formulated with low-temperature additives. **D-1014** significantly reduces torque requirements, counters the extreme drying effects produced by liquefied petroleum gases and lubricates long after other types of lubricants have been washed out. Sealweld® **Low-Temperature Lubricant D-1014** makes an excellent gear box lubricant. Recommended for use in LPG/ NGL services including propane, butane, ethane, ethylene and related by-products. Ideal for use in ball, gate, plug, wellhead valves and other valves designed to be left offline in extreme climate conditions and must be available for actuation as in the case of pig traps and launchers

Product Specification	
Base Oil	Synthetic
Colour	Grey
Drop Point	None
Texture	Thin Paste
Pressure	10,000 PSI
NGLI Grade	1
ASTM Penetration	230 - 290
Special Additives	Graphite & PTFE
Flash Point	+ 221°C or + 430°F
Melting Point	None
Temperature Range	- 54°C to + 204°C - 75°F to + 400°F

Order Details With PTFE	
Ordering Size	Part No.
11 Ounce Cartridge - 1 Single	S-DS-HG
15 Ounce Cartridge - 1 Single	S-DS-SG
11 Ounce Cartridges - 16/Case	S-DS-HGC
15 Ounce Cartridges - 12/Case	S-DS-SGC
10 Pound Can	S-DS-10P
40 Pound Pail	S-DS-40P
120 Pound Drum	S-DS-120D
400 Pound Drum	S-DS-400D

Order Details No PTFE	
11 Ounce Cartridge - 1 Single	S-DSX-HG
15 Ounce Cartridge - 1 Single	S-DSX-SG
11 Ounce Cartridges - 16/Case	S-DSX-HGC
15 Ounce Cartridges - 12/Case	S-DSX-SGC
10 Pound Can	S-DSX-10P
40 Pound Pail	S-DSX-40P
120 Pound Drum	S-DSX-120D
400 Pound Drum	S-DSX-400D

## Eterna-Lube #1000

Anti-seize compound and high-temperature lubricant for use in severe service conditions. Use in gear boxes, stem extensions and steam service.

### DESCRIPTION

Sealweld® **Eterna-Lube #1000** is a superior multi-use, anti-seize compound formulated to provide rust and corrosion protection for all metal surfaces by forming a protective coating. Enhanced with additives that create an impenetrable barrier that will withstand extreme heat, pressure and friction, reduce torque requirements and eliminate wear. **Eterna-Lube #1000** is waterproof, non-melting, highly resistant to chemicals and gases (except oxygen) and will not harden.

Sealweld® **Eterna-Lube #1000** is the recommended valve seat lubricant in high-temperature services including hydrocarbons, hot air and steam.

Recommended for use in: valve stems, gear boxes, expansion joints, conveyor belts, air motors, pumping mechanisms, all threaded connections, hand and motor-operated valves, gaskets, flanges, O-rings, bushings, bearings, rollers, gears, transmission boxes, chains, drives, automotive chassis, wheel bearings, universal joints, electric motors, compressors, hoists, turbines, winches, furnaces, burner assemblies, regulators, pumps, control chests, headers, cylinder head assemblies, gasket manifold assemblies, stud assemblies, fuel injectors, pre-combustion chambers, valve cages, turbo charger fittings, guides, fine thread tubing, compressor cages, silencer piping, shaft coupling bolts, keyways, spark plugs, torque rod pins and lubes, air cylinder assemblies, pneumatic cylinder shafts, liquid fuel pumps, air slides and axle shafts.

NOT recommended for use in high-speed bearings.

Product Specification	
Base Oil	Synthetic
Colour	Silver Grey
Drop Point	+ 327°C or + 621°F
NLGI Grade	1
ASTM Penetration 60 Strokes	240 - 330
Specific Gravity	1.30
Flash Point (Base Oils)	+ 302°C or + 575°F
Thermal Decomposition Point	+ 371°C or + 700°F
Spontaneous Ignition Point	+ 487°C or + 910°F
Freeze Point	- 22°C or - 8°F
Temperature Range	- 40°C to + 1093°C - 40°F to + 2000°F

Order Details	
Ordering Size	Part No.
16 Ounce Brush Top Can	S-EL-BT
16 Ounce Brush Top Can- 12/Case	S-EL-BTC
11 Ounce Cartridge - 1 Single	S-EL-HG
15 Ounce Cartridge - 1 Single	S-EL-SG
11 Ounce Cartridges - 16/Case	S-EL-HGC
15 Ounce Cartridges - 12/Case	S-EL-SGC
10 Pound Can	S-EL-10P
40 Pound Pail	S-EL-40P
120 Pound Drum	S-EL-120D
400 Pound Drum	S-EL-400D



## CHAMELEON

### Emergency Valve Body Sealant

Sealweld® **Chameleon Seal** should ONLY be used by EXPERIENCED professional pipeline valve technicians. Use ONLY after ALL conventional seat sealing methods have proven ineffective.

Recommended for use on CRITICAL valves. 98% success rate!

#### DESCRIPTION

**Chameleon Seal** is a proprietary blend of semi-synthetic compounds designed specifically for sealing severe valve seat leakage in downstream seating ball and gate valves. Cycle the valve to the fully open position. Flush the body cavity with an approved solvent solution in case contaminants have collected in the body cavity. Inject **Chameleon Seal** directly into the body cavity. DO NOT inject **Chameleon Seal** into the seat sealant system. DO NOT overfill the body cavity. DO NOT exceed the maximum body pressure rating.

**Chameleon Seal** is the ULTIMATE emergency valve sealant.

Ideal for use at offshore platforms and sub-sea valves.

Product Specification	
Base Oil	Semi-synthetic
Colour	Blue/ Green
Drop Point	> + 260°C or > + 500°F
Texture	Thin paste
Pressure	10,000 PSI
ASTM Penetration	225 - 270
Compatibility	Excellent
Solvent Resistance	N/A
Special Additives	PTFE
Particle Size	Semi-micronized
Temperature Range	- 20°C to + 170°C - 5°F to + 336°F

Order Details	
Ordering Size	Part No.
10 Pound Can	S-CS-10P
40 Pound Pail	S-CS-40P
400 Pound Drum	S-CS-400D

## GRIZZLY SEALANT

### Emergency Valve Body Sealant

Sealweld® **Grizzly Sealant** should ONLY be used by EXPERIENCED professional pipeline valve technicians. Use ONLY after ALL conventional seat sealing methods have proven ineffective.

Recommended for use on CRITICAL valves. Ideal for use in wellhead/master valves.

#### DESCRIPTION

**Grizzly Sealant** is a proprietary blend of semi-synthetic compounds designed specifically for sealing severe valve seat leakage in downstream seating ball and gate valves. Cycle the valve to the fully open position. Flush the body cavity with an approved solvent solution in case contaminants have collected in the body cavity. Inject **Grizzly Sealant** directly into the body cavity. DO NOT inject **Grizzly Sealant** into the seat sealant system. DO NOT overfill the body cavity. DO NOT exceed the maximum body pressure rating.

**Grizzly Sealant** is the LAST RESORT emergency valve sealant.

Ideal for use at offshore platforms and sub-sea valves.

Product Specification	
Base Oil	Semi-synthetic
Colour	Brown
Drop Point	> + 260°C or > + 500°F
Texture	Thick paste
Pressure	10,000 PSI
ASTM Penetration	225 - 270
Compatibility	Excellent
Solvent Resistance	N/A
Special Additives	VespeI
Particle Size	Semi-micronized
Temperature Range	- 20°C to + 170°C - 5°F to + 336°F

Order Details	
Ordering Size	Part No.
10 Pound Can	S-GS-10P
40 Pound Pail	S-GS-40P
400 Pound Drum	S-GS-400D



**GOTTA LEAK??  
SEAL IT!!  
Contact Sealweld®!**





## SAGD

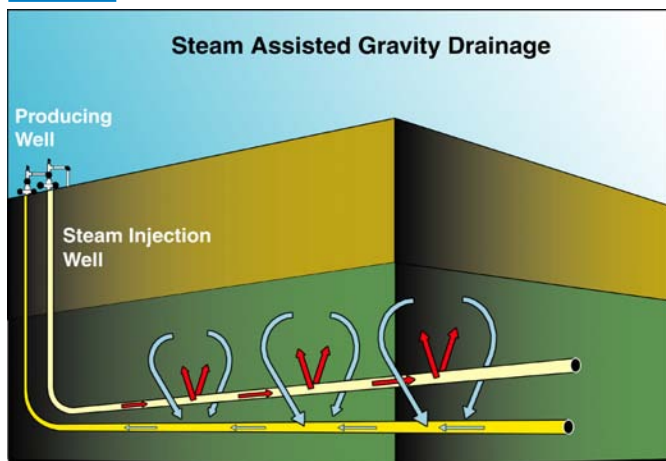

**SAGD** is a thermal method for recovering heavy oil. The process uses twin horizontal wells drilled and extended into the base of a reservoir with the horizontal steam injector placed directly above the horizontal production well. The mobilized oil drains by gravity to the lower well and is produced to the surface. The SAGD-based technology was developed in Alberta, Canada.

Sealweld® has developed **Steam Shield 2000**, a unique specialty synthetic valve lubricant tested and proven to remain stable at extremely high temperatures. **Steam Shield 2000** is recommended specifically for use in valves used for steam injection and heavy oil recovery. Also recommended for use in building steam-heating systems, geothermal service, etc.

### CASE STUDY

The original field pilot began in spring 2002. Several wellhead valves were filled with **Steam Shield 2000** lubricant and then put into service. Steam was injected into the formation at + 295°C/ + 563°F continuously for the first year. At the first maintenance interval the same wellhead valves were re-lubricated with additional **Steam Shield 2000**.

**Observations:** **Steam Shield 2000** remained exceptionally stable with very little to no break down or hardening occurring. **Steam Shield 2000** helped to dissipate the heat caused by the extreme high-temperature steam injection and hot oil production. The presence of this inert lubricant helped prevent internal seat seal damage, wash-outs and cuts normally associated with this high-temperature and high-pressure service.

Wellhead valves protected by **Steam Shield 2000** will exhibit prolonged valve service life. Wellhead valves in nearby fields, using the same SAGD technology, were found to be exhibiting extensive seal damage and in many cases severe seat leakage. These valves were injected with conventional high-temp lubricants or none at all.

High-temperature wellhead repair costs become prohibitively expensive when the cost of lost production revenue is taken into consideration. Protect your company's investment -- use **Steam Shield 2000** on all of the SAGD wellheads at your facility.

## Steam Shield 2000

Synthetic lubricant/ sealant and protective coating for valves in EXTREMELY high-temperature service, including SAGD, geothermal and steam-heating applications.

Ideal for use in university, hospital and other institution steam-heating systems.

### DESCRIPTION

Sealweld® **Steam Shield 2000** is a proprietary blend of synthetic ingredients that when combined, exceed the ratings of the components. As a result, **Steam Shield 2000** lubricant/ sealant withstands temperatures up to + 398°C or + 750°F without thermal decomposition.

**Steam Shield 2000** provides an insoluble film of synthetic lubricant to protect valve seal faces and reduce torque requirements. **Steam Shield 2000** is non-melting and insoluble in water, steam and related by-products. Tested in California and Alberta's steam-enhanced recovery projects as a valve and stuffing box sealant, **Steam Shield 2000** demonstrated excellent results. The viscosity of **Steam Shield 2000** allows for ease of application using a brush, grease pump or automatic injection equipment.

In cases of extreme valve leakage where regular sealants do not achieve desired results, Sealweld® offers a full range of specialty sealants to achieve a reliable temporary seal.

### Product Specification

Base Oil	Synthetic
Colour	Black
Drop Point	+ 327°C or + 621°F
Texture	Tacky
NLGI Grade	1
ASTM Penetration	260 - 340
Compatibility	Excellent
Water Resistance	Excellent
Special Additive	Moly
Particle Size	< 4 Microns
Composition	Semi-liquid
Temperature Range	- 30°C to + 400°C - 21°F to + 750°F

### Order Details

Ordering Size	Part No.
11 Ounce Cartridge - 1 Single	S-SS-HG
15 Ounce Cartridge - 1 Single	S-SS-SG
11 Ounce Cartridges - 16/Case	S-SS-HGC
15 Ounce Cartridges - 12/Case	S-SS-SGC
10 Pound Can	S-SS-10P
40 Pound Pail	S-SS-40P
120 Pound Drum	S-SS-120D
400 Pound Drum	S-SS-400D

## Steam Shield Sticks

Extreme high-temperature valve stem and pump packing.

### DESCRIPTION

**Steam Shield Sticks** are blended with specially processed Vespe<sup>®</sup> particles for extremely high-temperature sealing capability.

\* Vespe is the registered trademark of E.I. duPont de Nemours and Co

Product Specification	
Temperature Range	- 22°C to + 400°C - 8°F to + 750°F

Order Details - High-Temperature Packing	
Ordering Size	Part No.
10 ounce Jar - approx/100 Sticks "B"	P-HTS-100J
Pail - approx/7.5 Pounds 1000 "B"	P-HTS-7.5
"J" Stick - 8 ounce	P-HTS-SP-J

Order Details - Stem Packing	
Ordering Size	Part No.
10 Ounce Jar - approx/100 Sticks	P-HTS-SP-100J
Pail - approx/7.5 Pounds	P-HTS-SP-7.5

## Slick Sticks

Moldable valve stem packing sticks. Use in wellhead gate valves, plug valves and as a supplemental pump gland packing.

### DESCRIPTION

Sealweld<sup>®</sup> **SLICK STICKS** are made of a moldable packing putty with a proprietary blend of PTFE particles which bond to form a durable yet replaceable seal.

**SLICK STICKS** provide maximum sealing and lubricating efficiency when injected into ball, gate, or plug valves, stuffing boxes, pump glands and expansion joints. Can be used in high-pressure and corrosive service, all types of pumps and stuffing boxes and packing glands. Sealweld<sup>®</sup> **SLICK STICKS** are insoluble in water, oil, sweet or sour natural gas and related by-products. Recommended for use at: refineries, wellheads, pump or compressor stations and in gas distribution systems.

Note: When using **SLICK STICKS** on centrifugal pumps, the maximum surface speed of the shaft should not exceed 1000 feet per minute. i.e. Maximum shaft size and speed is 2.25 inch diameter shaft rotating at 1800 RPM.

Product Specification	
Temperature Range	- 40°C to + 260°C - 40°F to + 500°F

Order Details - High-Temperature Packing	
Ordering Size	Part No.
'J' Stick - 1 Stick	P-SP-J
Jar - approximately 100 'B' Sticks	P-SP-100J
Pail - approximately 1,000 'B' Sticks	P-SP-1MP

## Pack-It Particle Pak

A multi-purpose self-forming packing made with specifically processed granulated PTFE.

### DESCRIPTION

Sealweld<sup>®</sup> **Pack-It** is a granular multi-purpose self-forming packing made with specially processed PTFE. Sealweld<sup>®</sup> **Pack-It** compacts to form a rigid but flexible self-sealing packing which will conform to any size or type of shaft, rod or stuffing box. Simple in application and durable in service, this product ends the need for expensive inventories of various sizes of packing rings. Sealweld<sup>®</sup> **Pack-It** will not decompose, oxidize, or deteriorate and compensates for wear simply by remolding itself when the packing gland is adjusted. May be used as a valve stem packing on all valves, including ball, gate, plug, check, globe, motor and control valves regardless of service. Also used in conjunction with conventional rope packings to extend packing life and eliminate leakage at start-up.

Product Specification	
Temperature Range	- 240°C to + 250°C - 400°F to + 500°F

Order Details - Stem Packing	
Ordering Size	Part No.
Jar - approx/10 ounce	P-PK-10J
Pail - approx/6.25 Pounds	P-PK-6.25

## Pack King #301

Moldable plastic valve stem packing sticks. Similar to **SLICK STICKS** with a higher concentration of PTFE.

### DESCRIPTION

Sealweld<sup>®</sup> **Pack King #301** is a putty-type PTFE packing compound made from a 100% synthetic base formulated as an injectable packing for valve stems, packing glands and stuffing boxes. Designed to mold around valve stems and pump rods to form a drip-tight seal where other sealing procedures prove ineffective. Sealweld<sup>®</sup> **Pack King #301** exhibits an extremely low coefficient of friction and is resistant to most chemicals and solvents. Resistant to today's most exotic products and ideal for condensate service. Sealweld<sup>®</sup> **Pack King #301** is also available in bulk containers for use as a flange sealant.

Product Specification	
Temperature Range	- 29°C to + 250°C - 20°F to + 500°F

Order Details - Stem Packing	
Ordering Size	Part No.
'J' Stick - approx/8 ounce Stick	P-301-J
'B' Sticks - approx/12 ounce Jar	P-301-12J

**SEALEX®****Hydraulic System Leak Preventer****DESCRIPTION**

**SEALEX®** is an inert fluorocarbon compound which exhibits the BEST lubricating qualities of any solid material known.

**SEALEX®** will mix readily with either petroleum or synthetic-based fluids.

**SEALEX®** micro-fine particles will move into leak paths around seals and threaded connections on all hydraulic equipment and will stop leaks and weeps in a short time, while aiding in the lubrication of all moving parts.

Order Details	
Ordering Size	Part No.
6.5 gram Vials - 12 Vials per Box	P-SX-65C
1 Pound Jar	P-SX-16J
6.5 gram Vials - 12 Boxes/Master Case	P-SX-MC

**USAGE INSTRUCTIONS****POWER STEERING**

Add 1/2 vial to oil reservoir while turning steering wheel

**BULLDOZERS, GRADERS, BACKHOES, ETC.**

Add 1 vial for every ten gallons in the system

**FORK LIFTS**

Add 1 or 2 vials depending on the size of lift

**FARM MACHINERY**

Add 1/2 to 1 vial per unit

**HYDRAULIC HOISTS**

Add 1 vial for every gallon in the system

**RADIATORS**

Add 1 vial

**SEALEX®** will stop weeps in the radiator and hose connections and will lubricate the water pump

When possible, hand-mix **SEALEX®** in a small amount of hydraulic fluid for pouring through filler spouts; this will ensure that all of the micro-fine particles reach the oil system.



**GOTTA LEAK??  
SEAL IT!!  
Contact Sealweld®!**

**Product Weights and Dimensions**

DESCRIPTION	QTY	U/M	SHIPPING WEIGHTS & DIMENSIONS			
			IMPERIAL		METRIC	
SEALANT STICKS						
'A' Sticks	108	box	0.71 pounds	4-3/4" x 4" x 1-1/4"	0.33 kgs.	121 x 102 x 32 mm.
'B' Sticks	72	box	0.71 pounds	4-3/4" x 4" x 1-1/4"	0.33 kgs.	121 x 102 x 32 mm.
'C' Sticks	32	box	0.71 pounds	4-3/4" x 4" x 1-1/4"	0.33 kgs.	121 x 102 x 32 mm.
'D' Sticks	28	box	0.71 pounds	4-3/4" x 4" x 1-1/4"	0.33 kgs.	121 x 102 x 32 mm.
'G' Sticks	14	box	0.71 pounds	4-3/4" x 4" x 1-1/4"	0.33 kgs.	121 x 102 x 32 mm.
'J' Sticks	16	box	8.6 pounds	12" x 9-1/2" x 4"	3.9 kgs.	305 x 242 x 102 mm.
'K' Sticks	12	box	8.6 pounds	12" x 9-1/2" x 4"	3.9 kgs.	305 x 242 x 102 mm.
SEALANT CARTRIDGES						
Fits Hydraulic Pump	1	ea.	1 pounds		0.9 kgs.	229 x 229 x 223 mm.
Case	16	cs.	13 pounds	9" x 9" x 8-3/4"	6 kgs.	229 x 229 x 223 mm.
MasterCase	64	mc.	56.5 pounds	18-1/2" x 18-1/2" x 9-1/2"	26 kgs.	470 x 470 x 242 mm.
Fits SuperGun	1	ea.	1 pound		0.45 kgs.	229 x 229 x 223 mm.
Case	16	cs.	13.5 pounds	7" x 9" x 11"	6.2 kgs.	254 x 229 x 172 mm.
MasterCase	64	mc.	56.5 pounds	18-1/2" x 14-1/2" x 11"	26 kgs.	470 x 369 x 280 mm.
BULK GREASES						
10 pound Can	1	ea.	11.5 pounds	8" x 8" x 8-3/4"	5.2 kgs.	204 x 204 x 223 mm.
Case - 10 pound Cans	4	cs.	46.5 pounds	16" x 16" x 9"	22 kgs.	407 x 407 x 229 mm.
40 pound Pail	1	ea.	43.75 pounds	15" x 12" x 12"	20 kgs.	381 x 305 x 305 mm.
110 or 120 pound Drum	1	ea.	125 pounds	33" x 14-1/2" x 14-1/2"	57 kgs.	839 x 369 x 369 mm.
400 pound Drum	1	ea.	440 pounds	35" x 25" x 25"	200 kgs.	889 x 635 x 635 mm.





## Sealweld® High-Pressure Sealant Injection Pumps

Sealweld® Sealant Injection Pumps are specifically designed to safely inject viscous sealants into valves operating under pressure. ALWAYS use a high-pressure gauge and learn how to 'read' it. Make sure the hose assembly and all of the components are; rated to the maximum working pressure (MWP) of the pump and are in good working order.

Our pumps have been designed for years of continuous service in demanding field conditions and are preferred by professionals around the world.

The Sealweld® **SuperGun®** is the best manual sealant pump in the world and is designed for easy field repair, quick sealant delivery and extremely high injection pressure, if ever required.

The Sealweld® **Uni-Seal™** and **ACTIV-8®** pumps use a unique air/ hydraulic motor and direct-push technology to safely inject even the most viscous and heavy sealants quickly and efficiently. We recommend each crew have 2 pumps, one for injecting cleaner and the other for sealant. This eliminates having to empty the pump when changing products and cuts overall maintenance time considerably.

Sealweld® can repair all makes of high-pressure sealant injection guns and pumps. We carry a vast inventory of parts and provide instructions for doing your own repairs. Our pump technicians will do repairs and pump repair training at your field location.

### SEALANT INJECTION PUMP COMPARISONS

PUMP	TYPE	MAXIMUM DISCHARGE	LOADED CAPACITY	DISCHARGE VOLUME
Hydraulic Hand-Held	Manual	10,000 PSI	12 Ounces	1 Ounce/ 50 Strokes
SuperGun	Manual	15,000 PSI	16 Ounces	1 Ounce/ 25 Strokes
Uni-Seal™	Pneumatic/ Hydraulic	10,000 PSI	16 Ounces	16 Ounces/ < 2 Minutes
ACTIV-8®	Pneumatic/ Hydraulic	10,000 PSI	160 Ounces	16 Ounces/ < 2 Minutes

\* Larger pumps available on request.

Sealweld® injection guns and pumps are designed to pump all types of valve cleaners, lubricant/ sealants and emergency valve sealants.

The use of a gauge will assist you in determining what is happening inside the valve during injection.

ALWAYS keep your gun or pump loaded and in top working order in case of an emergency.



# Sealweld®

**NEVER use an automotive type grease gun for injecting into a valve under pressure!**

## ACTIV-8®

Sealweld® **ACTIV-8®** is the favorite pump of professional valve technicians. The **ACTIV-8®** is capable of drawing product directly from a 10 pound can and is capable of running on compressed air, bottled air or natural gas in an emergency.\*

\* Consult your company's safety policy BEFORE operating with natural gas

### G-A8GUN-C

- Generates up to 10,000 PSI injection pressure when required
- Controls the quantity of lubricant/ sealant being injected; prevents over-lubrication
- Rugged steel frame and pneumatic tires make this pump ideal for field and plant work
- Air/ hydraulic motor is powered by compressed air, bottled air or natural gas \*
- Simple design makes field repairs quick and easy
- Delivers lubricant/ sealant at up to 1 pound every 70 seconds
- High speed action cuts valve maintenance time by up to 75% on large diameter valves and at facilities with many valves
- Patented **ACTIV-8®** delivers valve cleaners, lubricants and sealants faster than any other pump on two wheels
- High-speed action and 10 pound (5 quart) capacity makes this pump ideal for pipelines and large plants
- Complete with 10 foot sealant hose, swivels and coupler. 15,000 PSI gauge and guard is also standard equipment. Longer hoses are available on request
- Built-in air filter/ lubricator system
- Each gun comes complete with an owner's manual and an 8 minute DVD describing safe operating procedures

Order Details	
Description	Part No.
Sealweld® ACTIV-8® Pump - Complete	G-A8GUN-C
<i>Includes:</i>	
10 foot/ 120 inch High-Pressure Hose	H-HS-120HP
15,000 PSI High-Pressure Gauge /w Guard	H-GD-01C
Swivels	H-SV-ST1 H-SV-L1
Coupler	H-CPSG-2
Owner's Manual	A-M-A8
8-Minute Operating Instructions on DVD	D-VD-A8
Release Valve	H-RVAB

Check out our  
Ngrain modeled pumps at:  
<http://www.valvepro.com/Ngrain/>

### Product Specification

Maximum Inlet Air Pressure	120 PSI
Recommended Air Volume	20 CFM
Maximum Discharge Pressure	10,000 PSI
Delivery Rate	16 ounces/ +/- 70 seconds
77% Fewer Moving Parts	Less wear
Re-load Time	< 30 seconds
Sealant Capacity	10 pounds/ 5 quarts
Air/ Hydraulic Motor	Serviceable world-wide
100% Guarantee	1 Year - Normal use
Repairable	In the field or shop

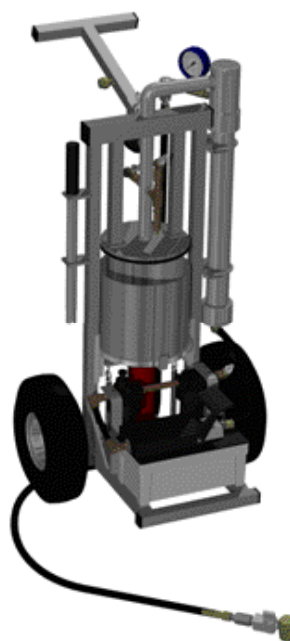

NOTE: The air/hydraulic motor may be powered by natural gas in an emergency, it is not recommended and may void warranty.

### 2-Year Spare Parts #R-A8-SPARES-2Y

Qty	Description	Part No.
4	Loading Tube O-Ring	R-A8-11B
2	Loading Plate O-Ring	R-A8-09A
2	Relief Valve - 200 PSI	R-A8-14F
2	Barrel Gasket	R-A8-19A
2	Barrel O-Ring	R-A8-19C
2	Nylon Piston Cup	R-A8-20C
2	Piston O-Ring	R-A8-20E
2	Inner Leather Cup	R-HG08H
4	Loading Plate O-Ring - Nitrile	R-A8-09A
4	Check Valve	R-A8-14D
4	Axle - 1/2" x 3-1/4" - New Style	R-A8-03P5
2	Large Filter Element Kit	R-A8-15H-KIT
2	Hydraulic Oil - One Gallon	R-HOGALL
2	Mineral Oil - Pint Bottle	R-MINPINT
2	OTC Model 'F' - Major Repair Kit	R-A8-OTC-300805
2	Release Valve Kit	R-A8-OTC-200383



## ACTIV-8® Parts Break-Down

Sealweld® **ACTIV-8®** is the favorite pump of professional valve technicians. The **ACTIV-8®** is capable of drawing product directly from a 10 pound can and is able to be run on compressed air or bottled air.

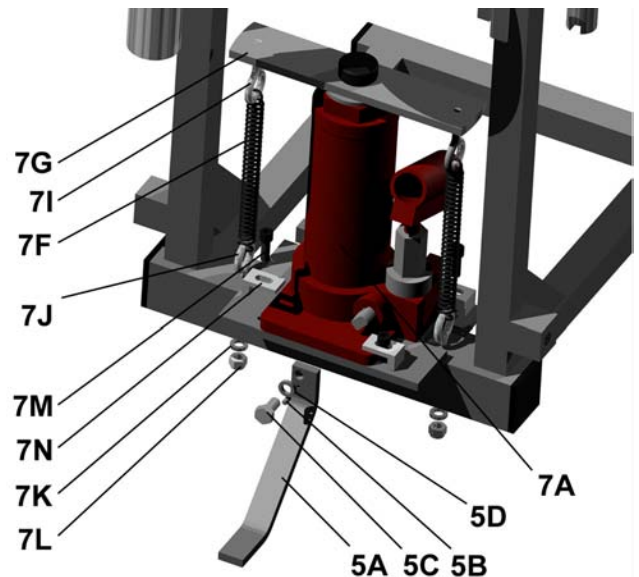
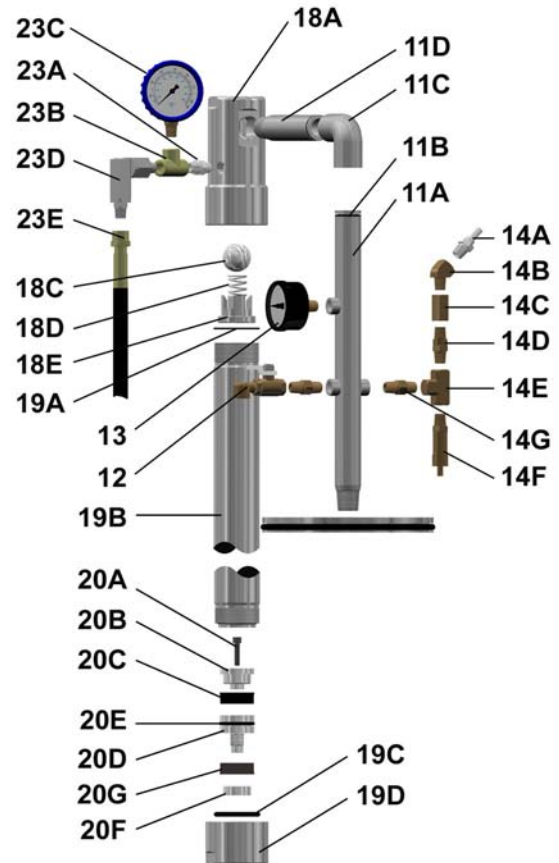
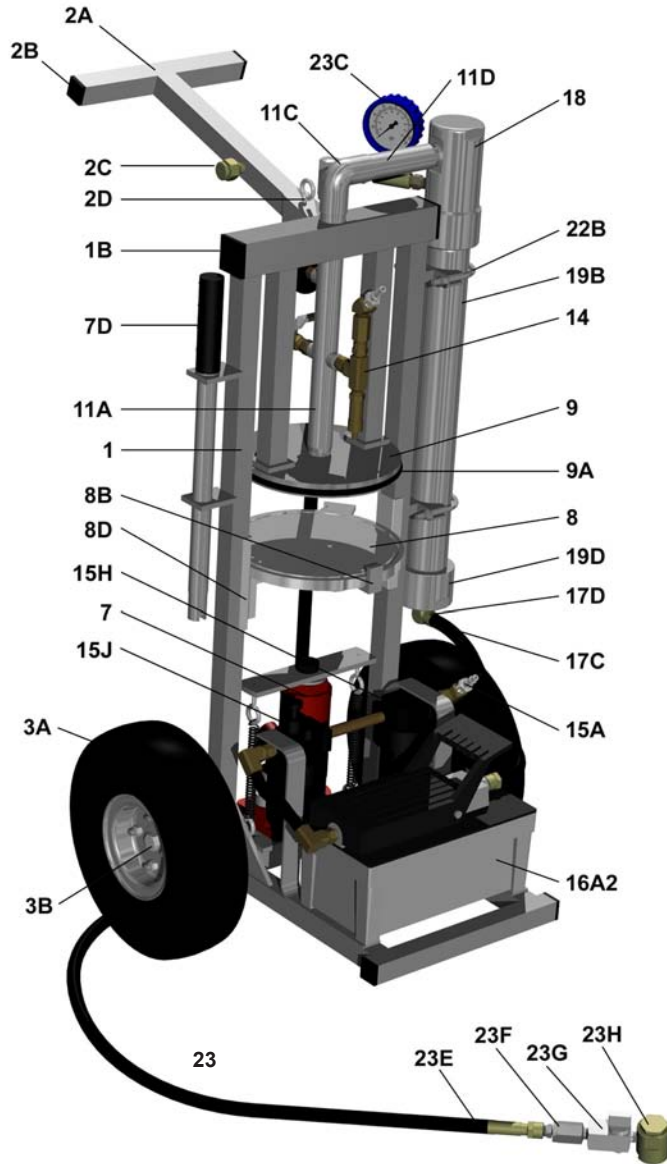

**Sealweld**

Rental units available for short  
or long-term contracts.



## ACTIV-8® Parts List

REF	DESCRIPTION	PART No.	
1	ACTIV-8® FRAME (BARE)	R-A8-01	1
1B	1-1/2" FRAME PLUGS	R-A8-01B	4
	T-HANDLE ASSEMBLY	R-A8-02	
2A	T-HANDLE (BARE)	R-A8-02A	1
2B	1" FRAME PLUGS	R-A8-02B	4
2C	CAPPED SEALANT FITTING 1/4" CARBON STEEL	F-SC1/4-BH-CS	1
2D	T-HANDLE LARGE EYE HOOK	R-A8-53	1
	WASHER - 1/4"	R-A8-32	1
	1/4" NYLON LOCK NUT	R-A8-33	1
3A	PNEUMATIC WHEEL	R-A8-03P1	2
3B	1/2" x 3-1/4" - NEW STYLE AXLE	R-A8-03P5	2
	KICK STAND ASSEMBLY	R-A8-05	
5A	KICK STAND	R-A8-05A	1
5B	KICK STAND SET SCREW	R-A8-05B	1
5C	KICK STAND BOLT	R-A8-34	1
5D	WASHER - 1/4"	R-A8-32	2
	1/4" NYLON LOCK NUT	R-A8-33	1
7	JACK ASSEMBLY	R-A8-07	
7A	JACK	R-A8-07A	1
	JACK COLLAR	R-A8-07AC	1
	JACK HANDLE WITH GRIP ASSEMBLY	R-A8-07B	
7D	JACK HANDLE WITH GRIP	R-A8-07B2	1
	WASHER - 1/4"	R-A8-32	1
	JACK BRACKET BOLT	R-A8-50A	1
7F	JACK PULL DOWN SPRINGS	R-A8-07C	2
7G	JACK PULL DOWN BAR	R-A8-07D	1
7I	UPPER EYE BOLTS	R-A8-29	2
7J	LOWER EYE BOLTS	R-A8-30	2
7K	WASHER - 1/4"	R-A8-32	2
7L	1/4" NYLON LOCK NUT	R-A8-33	2
7M	JACK BRACKET BOLTS	R-A8-50A	4
7N	JACK BRACKET	R-A8-50B	4
8	ELEVATOR PLATE ASSEMBLY	R-A8-08	
8A	ELEVATOR PLATE	R-A8-08A	1
8B	ELEVATOR PLATE BACK STOP	R-A8-08B	1
8C	BACK STOP BOLT	R-A8-37	1
8D	SLIDE RAILS	R-A8-08C	2
8E	SLIDE RAIL SCREW	R-A8-52	4
	JACK EXTENSION ASSEMBLY	R-A8-08D	
8G	SWING BAR	R-A8-08D1	1
	DOWEL PIN - 1/8" x 1/2"	R-A8-08E	1
8H	SWING BAR BOLT - 5/16"	R-A8-39	1
8I	WASHER - 1/4"	R-A8-32	1
8J	SWING BAR STOP BOLT	R-A8-39A	1
9	LOADING PLATE	R-A8-09	1
9A	LOADING PLATE O-RING - NITRILE	R-A8-09A	1
9B	BONDED SEAL - 5/16"	R-A8-09D	2
9C	LOADING PLATE CAP SCREWS 5/16" x 1"	R-A8-09C	2
11A	LOWER LOADING TUBE	R-A8-11A	1
11B	LOADING TUBE O-RINGS - NITRILE	R-A8-11B	2
11C	LOADING TUBE ELBOW	R-A8-11C	1
11D	UPPER LOADING TUBE	R-A8-11D	1
12	VENT VALVE ASSEMBLY	R-A8-12A	1
13	LOADING TUBE GAUGE - 200 PSI	R-A8-13	1
14	BLOW DOWN ASSEMBLY	R-A8-14	
14A	MODIFIED AIR NIPPLE	R-A8-14A	1
14B	ELBOW - 45 DEGREE - LOW PRESSURE - M x F	R-A8-14B	1
14C	COLLAR - LOW PRESSURE - F x F	R-A8-14C	1
14D	CHECK VALVE	R-A8-14D	1
14E	LOW PRESSURE TEE	R-A8-14E	1
14F	RELIEF VALVE - 200 PSI	R-A8-14F	1
14G	LOW PRESSURE NIPPLE - 1/4"	R-A8-14G	1
	FILTER/ LUBRICATOR ASSEMBLY	R-A8-15	
15A	AIR NIPPLE	R-A8-15A	1

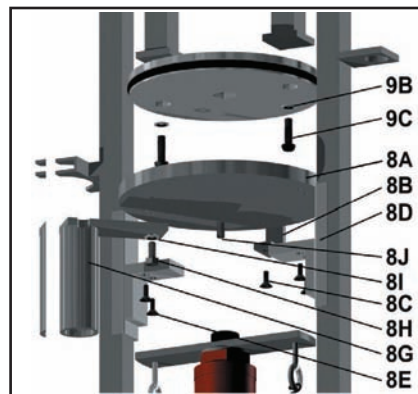

REF	DESCRIPTION	PART No.	
	AIR SWIVEL ELBOW	R-A8-15F3	1
	LOW PRESSURE HOSE	R-A8-15F4	1
	ELBOW - 90 DEGREE - L P- F x F	R-A8-15F7	2
	PIPE NIPPLE - LP - 3" - 1/4" NPT	R-A8-15F8	1
	PIPE NIPPLE - LP - 2" - 1/4" NPT	R-A8-15F9	2
	PIPE BRACKET SCREWS	R-A8-15G	4
	PIPE BRACKET NYLOCK LOCK NUTS	R-A8-15G2	4
	FILTER/LUBRICATOR PIPE BRACKETS	R-A8-15G3	2
15H	LARGE AIR FILTER UNIT	R-A8-15H	1
15J	LARGE LUBRICATOR - 1/4"	R-A8-15J	1
	LUBRICATOR/ FILTER BRACKET SET	R-A8-15K	1
16A2	AIR/ HYDRAULIC MOTOR - OTC PUMP	R-A8-16A2	1
	BOLT FOR METAL PUMP BOX	R-A8-31	4
	WASHER - 1/4"	R-A8-32	4
17C	OTC HYDRAULIC HOSE	R-A8-17C	1
17D	ELBOW - 90 DEGREE 1/4" M x 1/4" F	R-A8-17D	1
18	HEAD ASSEMBLY	R-A8-18	
18A	HEAD (BARE)	R-A8-18A	1
18C	STEEL FAG BALL FOR HEAD - 1-1/4"	R-A8-18C	1
18D	SPRING FOR HEAD	R-A8-18D	1
18E	FLOW WOLF CAGE FOR HEAD	R-A8-18E	1
	SEALANT BARREL ASSEMBLY	R-A8-19	
19A	BARREL GASKET	R-A8-19A	1
19B	SEALANT BARREL	R-A8-19B	1
19C	BARREL O-RING - NITRILE	R-A8-19C	1
19D	BARREL END CAP	R-A8-19D	1
	PISTON ASSEMBLY	R-A8-20	
20A	PISTON SCREW	R-A8-20A	1
20B	PISTON STOP	R-A8-20B	1
20C	NYLON PISTON CUP	R-A8-20C	1
20D	PISTON BODY	R-A8-20D	1
20E	PISTON O-RING	R-A8-20E	1
20F	PISTON END NUT	R-A8-20F	1
20G	LEATHER PISTON CUP	R-HG08H	1
	HEAD & BARREL ASSEMBLY	R-A8-21	
22B	'U' BOLTS	R-A8-22B	2
	WASHER - 1/4"	R-A8-32	4
	3/8" - 'U' BOLT - NYLOCK NUTS	R-A8-45	4
23	HIGH-PRESSURE HOSE ASSEMBLY	H-A-HOSE	
23A	ADAPTER - 1/4" M x 1/4" M	H-AD-4M4M	1
23B	HIGH-PRESSURE TEE - 1/4" F x 1/4" F	H-T-444	1
23C	HP GAUGE ASSEMBLY - 15,000 PSI	H-GD-01C	1
23D	'L' SWIVEL - 1/4" M x 1/2" - 27 M	H-SV-L1	1
23E	HP 10 FOOT HOSE - 3/8" - 10,000 PSI	H-HS-120HP	1
23F	STRAIGHT SWIVEL 1/4" M x 1/2" - 27 M	H-SV-ST1	1
23G	RELEASE VALVE 1/4" M x 1/4" F	H-RVAB	1
23H	GIANT BUTTONHEAD COUPLER	H-CPSG-2	1
	PAIL GUARD	R-A8-24	1
	PAIL GUARD WING NUTS - 5/16"	R-A8-48	2



## Uni-Seal™

The **Uni-Seal™** is the fastest hand-held air/ hydraulic injection pump on the market.

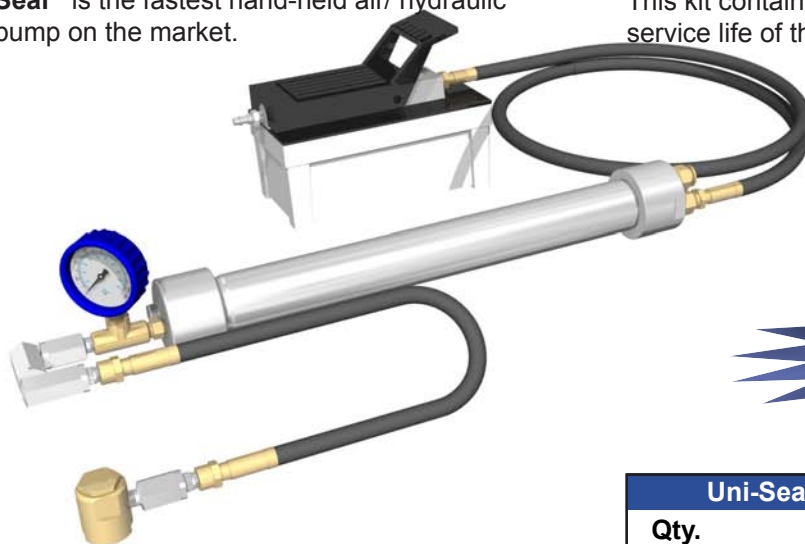

## Uni-Seal™ Pump Kits

This kit contains all the o-rings you'll need to extend the service life of this hand-held pump.

Check out our  
Ngrain modeled pumps at:  
<http://www.valvepro.com/Ngrain/>

### Product Specification

Maximum Inlet Air Pressure	120 PSI
Recommended Air Volume	20 CFM
Maximum Discharge Pressure	10,000 PSI
Delivery Rate	16 ounces/ 2 minutes
Re-load	EZ-LOADER
Sealant Capacity	10 or 15 ounce cartridges
Weight	25 pounds
100% Guarantee	1 Year - Normal use
Repairable	In shop

## G-UGUN-C

The **Uni-Seal™** pump has an air/ hydraulic motor that can be powered by compressed air, bottled air or natural gas. \*

Up to 10,000 PSI is quickly generated by stepping on the foot pedal making this pump ideal for servicing large diameter valves.

The high speed action of the **Uni-Seal™** pump makes it ideal for "popping" the plug out of it's seat in tapered plug valves that become hard-to-turn.

\* Consult your company's safety policy BEFORE operating with natural gas.

\* May void warranty.

### Order Details

Description	Part No.
Uni-Seal™ Pump - Complete	G-UGUN-C
High Pressure Hose Assembly	H-U-HOSE

### Uni-Seal™ Minor Repair Kit #R-UG-MIN

Qty.		Part No.
1	Barrel Gasket	R-A8-19A
2	Nylon Piston Cups	R-A8-20C
1	Piston O-Ring	R-A8-20E
1	Barrel O-Ring - Nitrile	R-A8-19C
2	Hydraulic Oil - One Pint	R-HOPINT

### Features include:

- Air over hydraulic hand-held pump for all makes of sealants, lubricants and cleaners
- Lightweight and portable
- Pumps 'J' sticks, Gun-Paks or bulk cleaner, lubricant or sealant
- Pumps 'K' sticks, Gun-Packs and all types of bulk lubricant/ sealants
- Use to lubricate, seal or clean: ball, gate or plug valves in minutes
- Makes valve maintenance simple
- Reduces valve maintenance costs
- Powered by the most reliable and easily serviced pump manufactured
- Will accept all types of grease containers including: bulk, bag, stick or cartridge with **EZ-Loader**
- Lubricant hose becomes carrying handle when coupled to large buttonhead fitting at base of pump
- Large buttonhead fitting becomes a spare valve fitting if needed

### 1-Year Spare Parts Repair Kit #R-UGUN-1Y

Qty.		Part No.
1	Uni-Seal™ Minor Repair Kit	R-UG-MIN
1	Hydraulic Oil - Gallon	R-HOGALL
1	Major Repair Kit Model "F"	R-A8-OTC-300805
1	Release Valve Kit	R-A8-OTC-200383

## Uni-Seal™ Parts List

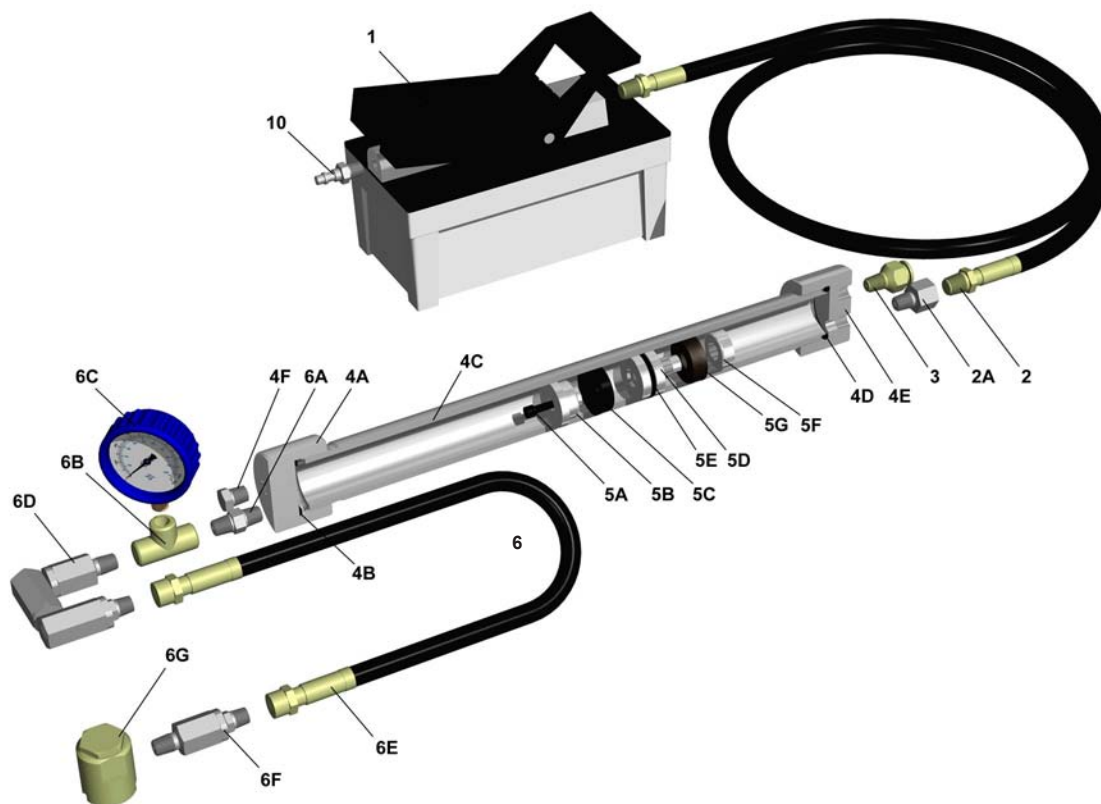

**Sealweld®**

Longer hoses available  
by request

REF	DESCRIPTION	PART #	QTY.
1	AIR/ HYDRAULIC MOTOR	R-A8-16A2	1
2	HIGH-PRESSURE HYDRAULIC HOSE	H-HS-72HYD	1
2A	3/8" F x 1/4" M NIPPLE	H-AD-6F4M	1
3	BUTTONHEAD FITTING FOR HOSE	F-SW1/4-CS	1
4	SEALANT BARREL ASSEMBLY	R-U2-1	1
4A	HEAD CAP	R-U2-1A	1
4B	BARREL GASKET	R-A8-19A	1
4C	SEALANT BARREL	R-A8-19B	1
4D	END CAP O-RING	R-A8-19C	1
4E	BOTTOM END CAP	R-UG-04	1
4F	1/4" M NPT PLUG	H-AD-4M	1
5	PISTON ASSEMBLY	R-A8-20	1
5A	PISTON SET SCREW	R-A8-44	1
5B	PISTON STOP	R-A8-20B	1
5C	NYLON PISTON CUP	R-A8-20C	1
5D	PISTON BODY	R-A8-20D	1
5E	PISTON O-RING	R-A8-20E	1
5F	PISTON END NUT	R-A8-20F	1
5G	INNER LEATHER CUP	R-HG08H	1
6	UNI-SEAL™ HOSE ASSEMBLY	R-U-HOSE	1
6A	ADAPTER NIPPLE	H-AD-4M4M	1
6B	HIGH-PRESSURE TEE	H-T-444	1
6C	15,000 PSI GAUGE	H-GD-01C	1
6D	HIGH-PRESSURE 'Z' SWIVEL	H-SV-Z1	1
6E	HIGH-PRESSURE SEALANT HOSE	H-HS-60XHP	1
6F	HIGH-PRESSURE STRAIGHT SWIVEL	H-HS-ST1	1
6G	GIANT BUTTONHEAD COUPLER	H-CPSG-2	1
7	MINOR REPAIR KIT	R-UG-MIN	
8	HYDRAULIC FLUID	R-HO-PINT	
9	AIR NIPPLE	R-A8-15A	1



## SuperGun® Screw-Primed Pump

The patented Sealweld® **SuperGun®** is designed for many years of rugged use.

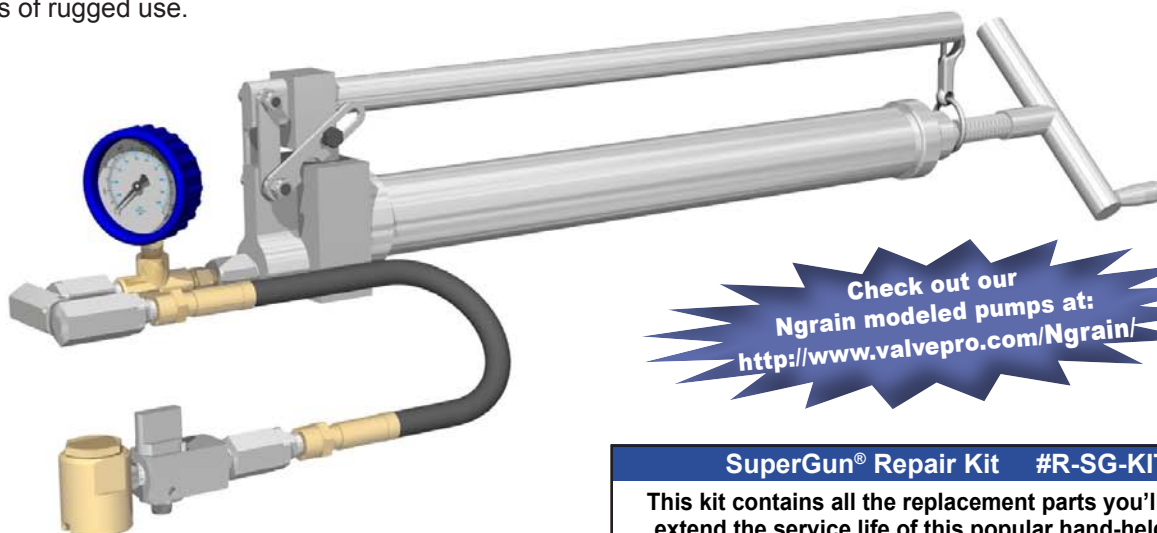

## SuperGun® Kits

Check out our  
Ngrain modeled pumps at:  
<http://www.valvepro.com/Ngrain/>

### Features include:

- Discharges 1 ounce of sealant easily with every 25 strokes
- Generates up to 15,000 PSI when required
- Large capacity barrel holds 33% more than other similar hand-held injection pumps
- Field-replaceable piston head cartridge
- Reloads easily with a 12 ounce or 16 ounce cartridge from **EZ-Loader**
- Pumps 'K' sticks, Gun-Packs and all types of bulk lubricant/ sealants

## G-SGUN-C

The Sealweld® **SuperGun®** has an extra long lever handle that makes high-pressure injection easy. It is lightweight and very portable. The screw-primed design indicates how much product remains in the barrel and the high-pressure check valve system prevents dangerous "kicks".

The **SuperGun®** has been designed to withstand the rigors of field use and every gun is tested prior to shipment. Durability, easy to carry and faster pumping make it the valve technician's favorite hand-held, high-pressure sealant injection pump for topping-up procedures when only small quantities of lubricant is required.

Order Details	
Description	Part No.
SuperGun® Screw-Primed Pump - Complete	G-SGUN-C
Includes: 18 inch high-pressure hose assembly with 15,000 PSI gauge.	
Plastic Carrying Case - optional	B-PC-SG

### SuperGun® Repair Kit #R-SG-KIT

This kit contains all the replacement parts you'll need to extend the service life of this popular hand-held pump.

Qty		Part No.
1	Piston Cartridge Assembly	R-SG-02
1	Barrel Gasket	R-SG-07A
1	Bonded Seal - 3/8"	R-SG-19B2
1	Leather Cup	R-SG-19D
1	Spring	R-SG-19F

### Linkage Assembly Kit #R-SG-17

This linkage kit contains all the replacement parts you'll need to extend the service of this popular hand-held pump.

Qty		Part No.
2	Harnes Links	R-SG-17A
1	Handle Pin	R-SG-17B1
1	Head Pin"	R-SG-17B3
5	Nylon Nut	R-SG-17C
1	Fulcrum Link	R-SG-18A
1	Fulcrum Bolt	R-SG-18B

### Primer Rod Assembly #R-SG-19

This primer rod assembly kit contains all the replacement parts you'll need to extend the service life of this popular hand held pump.

Qty		Part No.
1	End Nut	R-SG-19A
1	Bonded Seal - 3/8"	R-SG-19B2
1	Rod Bearing	R-SG-06B
1	Small Cup Washer	R-SG-19C
1	Leather Cup	R-SG-19D
1	Large Cup Washer	R-SG-19E
1	Spring	R-SG-19F
1	Shaft	R-SG-19G
2	Shaft Body Nut	R-SG-19H
1	Shaft Bearings	R-SG-19I
1	Shaft End Nut	R-SG-19J
1	Primer Rod Crank	R-SG-06A



## SuperGun® Pump Parts List

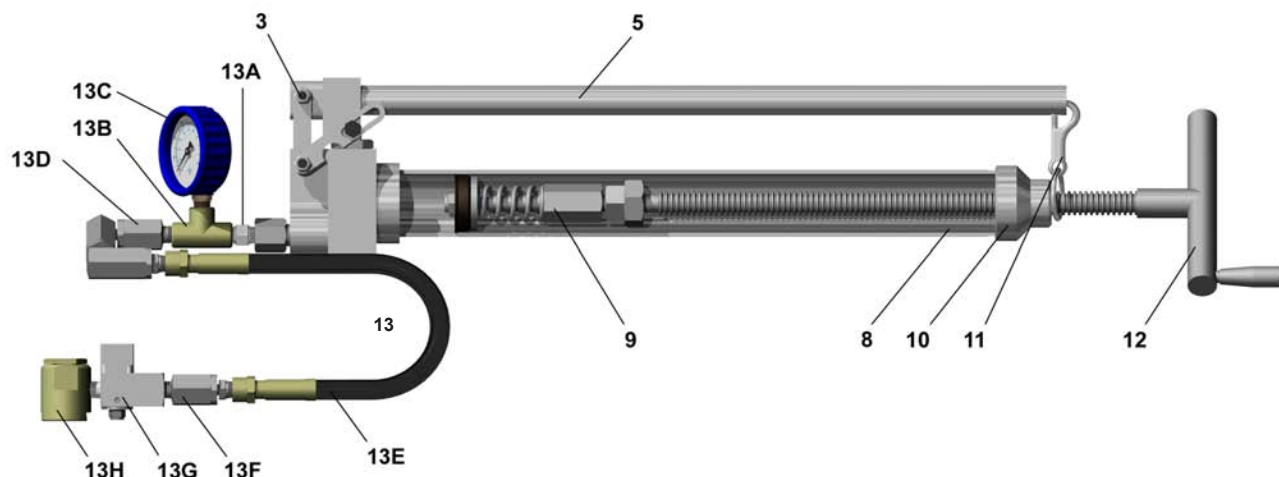

REF	DESCRIPTION	PART #	QTY.
1	FLOW WOLF® CHECK VALVE	R-SG-16	1
1A	CHECK VALVE SPRING	R-SG-01A	1
2	CHECK VALVE BALL	R-SG-16A	1
3	LINKAGE ASSEMBLY	R-SG-17	1
3A	HARNESS LINKS	R-SG-17A	2
3B	HANDLE PIN	R-SG17B1	1
3C	HEAD PIN	R-SG-17B3	1
3D	NYLOCK NUTS	R-SG-17C	5
3E	FULCRUM LINK	R-SG-18A	1
3F	FULCRUM BOLT	R-SG-18B	1
3G	HANDLE BUSHING	R-SG-03A	1
4	PISTON HEAD CARTRIDGE	R-SG-02	1
4A	BODY NUT	R-SG-02C	1
4B	PISTON O-RING	R-SG-02D	1
4C	BODY O-RINGS	R-SG-02E	3
5	HANDLE	R-SG-03	1
6	HEAD (BARE)	R-SG-01	1
7	BARREL GASKET	R-SG-07A	1
8	BARREL	R-SG-07	1
9	PRIMER ROD ASSEMBLY	R-SG-19	1
9A	END NUT	R-SG-19A	1
9B	BONDED SEAL - 3/8"	R-SG-19B2	1
9C	SMALL CUP WASHER	R-SG-19C	1
9D	LEATHER CUP	R-SG-19D	1
9E	LARGE CUP WASHER	R-SG-19E	1
9F	SPRING	R-SG-19F	1
9G	SHAFT	R-SG-19G	1
9H	SHAFT BODY NUT	R-SG-19H	1
9I	SHAFT BEARINGS	R-SG-19I	2
9J	SHAFT END NUT	R-SG-19J	1
9K	ROD BEARING	R-SG-06B	1
9L	ROD NUT	R-SG-06C	1
10	END CAP	R-SG-05	1
11	HANDLE CLASP AND RING	R-SG-04	1
12	PRIMER ROD CRANK	R-SG-06A	1
	OVERSIZED PISTON CARTRIDGE	R-SG-02LP	
13	SUPERGUN HOSE ASSEMBLY	H-S-HOSE	1
13A	1/4" M X 1/4" M NIPPLE	H-AD-4M4M	1
13B	HP TEE 1/4" F X 1/4" F X 1/4" F	H-T-444	1
13C	15,000 PSI GAUGE W/ GUARD	H-GD-01C	1
13D	'Z' SWIVEL 1/4" M X 1/2" - 27 M	H-SV-Z1	1
13E	1/4" X 18" HP HOSE 1/2" - 27 F ENDS	H-HS-18XHP	1
13F	STRAIGHT SWIVEL 1/4" M X 1/2"-27M	H-SV-ST1	1
13G	RELEASE VALVE 1/4" M X 1/4" F	H-RVAB	1
13H	GIANT BUTTONHEAD COUPLER	H-CPSG-2	1

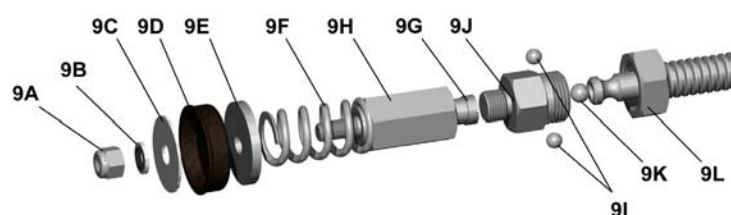
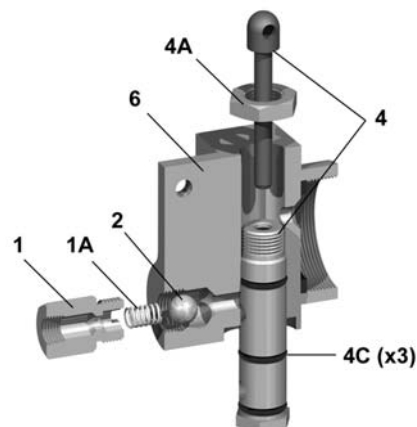
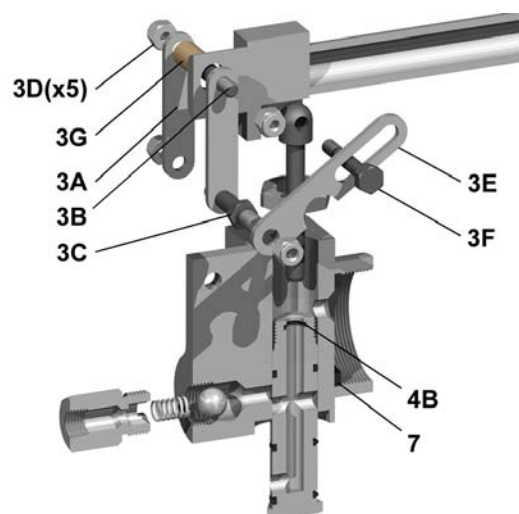



## Hydraulic Hand-Held Pump

The Sealweld® Hydraulic Hand-Held Pump is lightweight and very portable.

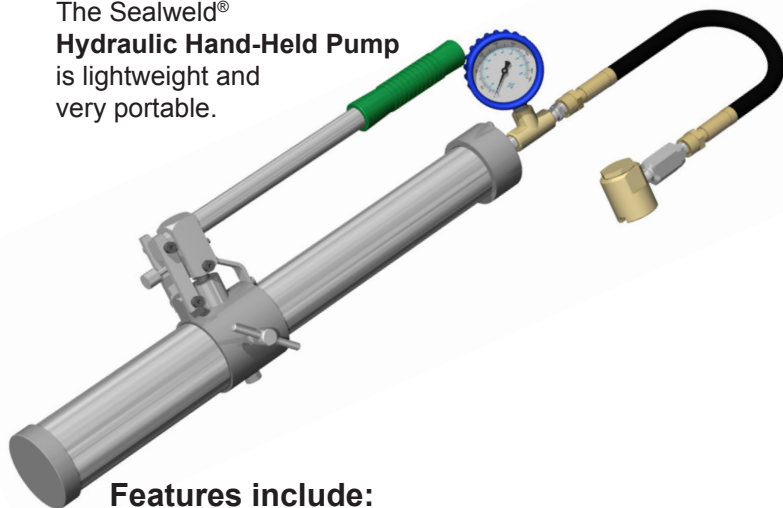

### Features include:

- Discharges 1 ounce of sealant easily with every 50 strokes
- Generates up to 10,000 PSI when required
- Self-priming hydraulic action makes manual injection simple
- Reloads easily with a 12 ounce cartridge from **EZ-Loader**
- Pumps liquids, flange sealants, stem packings, 'J' sticks, Gun-Packs and all types of sealants

Check out our  
Ngrain modeled pumps at:  
<http://www.valvepro.com/Ngrain/>

## G-HGUN-C

The Sealweld® Hydraulic Hand-Held Pump has a locking handle to prevent piston damage. It is lightweight and very portable. The compact size makes it easy to keep one in your general toolbox or behind the seat of your pickup for quick top-ups and emergency sealing jobs between regular maintenance intervals.

Ships with an 18 inch long hose, buttonhead coupler and high-pressure gauge, it is ready for loading and field use right out of the box. Perfect for pumping small quantities of valve cleaner, lubricant or sealant. No toolbox is complete without one.

Order Details	
Description	Part No.
Hydraulic Hand-Held Pump - Complete	G-HGUN-C
Includes: 18 inch high-pressure hose assembly with 15,000 PSI gauge	

## Hydraulic Hand-Held Pump Kits

This kit contains all the o-rings you'll need to extend the service life of this hand-held pump.

O-Ring Repair Kit #R-HGOREP	
Qty.	Part No.
1	Piston O-Ring R-A8-20E
1	Barrel O-Ring - Nitrile R-A8-19C
1	O-Ring - Nitrile R-HG11C
1	Bottom Cylinder O-Ring - Nitrile R-HG11D
1	By-Pass Valve O-Ring - Nitrile R-HG31
1	Hydraulic Relief O-Ring - Nitrile R-HG11K

Includes all of the O-Ring Repair Kit parts plus the parts required to repair or replace the major sub-assemblies quickly in the field.

Minor Repair Kit #R-HGMIN	
Qty.	Part No.
1	Nylon Piston Cup R-A8-20C
1	Piston O-Ring R-A8-20E
1	Inner Leather Cup R-HG08H
1	Barrel Gasket R-HG10A
1	Barrel O-Ring - Nitrile R-A8-19C
1	O-Ring - Nitrile R-HG11C
1	Bottom Cylinder O-Ring - Nitrile R-HG11D
1	Check Valve Assembly R-HG11F
1	By-Pass Valve R-HG11G
1	By-Pass Valve O-Ring - Nitrile R-HG31
1	Hydraulic Relief O-Ring - Nitrile R-HG11K
1	Hydraulic Fluid - One Pint R-HOPINT
1	Fluid Bag Assembly R-HG15

This complete kit includes all of the parts in the O-Ring and Minor Repair Kits, plus body and piston pump parts. This kit is ideal and you should keep one on hand at all times.

Major Repair Kit #R-HGMAJ	
Qty.	Part No.
1	Nylon Piston Cup R-A8-20C
1	Piston O-Ring R-A8-20E
1	Inner Leather Cup R-HG08H
1	Barrel Gasket R-HG10A
1	Barrel O-Ring - Nitrile R-A8-19C
1	O-Ring - Nitrile R-HG11C
1	Bottom Cylinder O-Ring - Nitrile R-HG11D
1	Check Valve Assembly R-HG11F
1	By-Pass Valve R-HG11G
1	By-Pass Valve O-Ring - Nitrile R-HG31
1	Hydraulic Relief O-Ring - Nitrile R-HG11K
1	Hydraulic Fluid - One Pint R-HOPINT
1	Fluid Bag Assembly R-HG15
1	Body Cylinder R-HG11B
1	Pump Piston R-HG11E

## Hydraulic Hand-Held Pump Parts List

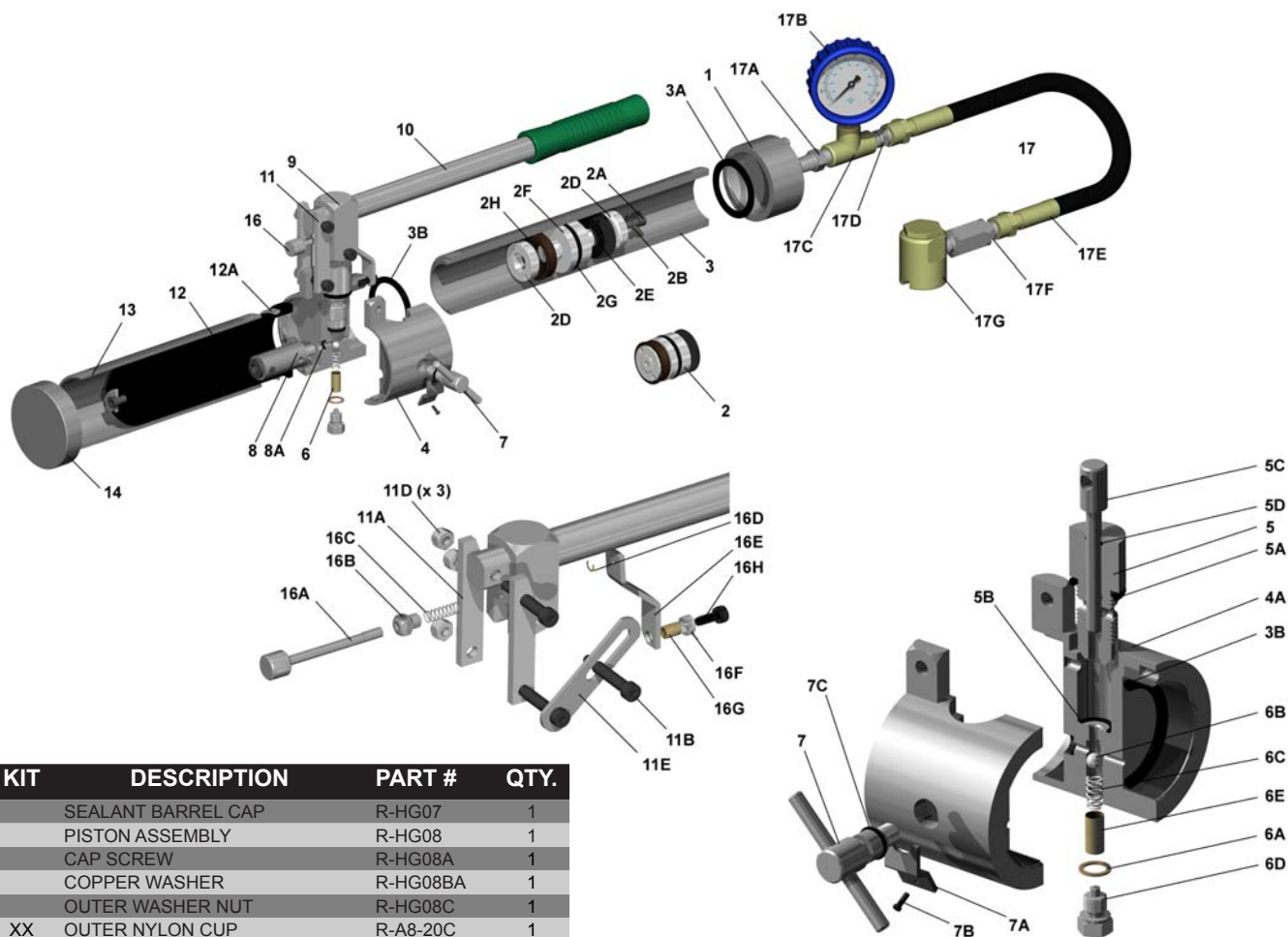

REF	KIT	DESCRIPTION	PART #	QTY.
1		SEALANT BARREL CAP	R-HG07	1
2		PISTON ASSEMBLY	R-HG08	1
2A		CAP SCREW	R-HG08A	1
2B		COPPER WASHER	R-HG08BA	1
2D		OUTER WASHER NUT	R-HG08C	1
2E	XX	OUTER NYLON CUP	R-A8-20C	1
2F		PISTON BODY	R-HG08E	1
2G	X	PISTON O-RING	R-A8-20E	1
2H	XX	INNER LEATHER CUP	R-HG08H	1
2I		INNER WASHER NUT	R-HG08I	1
3		SEALANT BARREL	R-HG09	1
3A	XX	BARREL GASKET	R-HG10A	1
3B	X	BODY/ BARREL O-RING	R-HG10	1
4		BODY ASSEMBLY	R-HG11	1
4A		BODY (BARE)	R-HG11A	1
5	XXX	HYDRAULIC PUMP CYLINDER	R-HG11B	1
5A	X	CYLINDER/ NECK O-RING	R-HG11C	1
5B	X	BOTTOM CYLINDER O-RING	R-HG11D	1
5C	XXX	PUMP PISTON	R-HG11E	1
6	XX	CHECK VALVE ASSEMBLY	R-HG11F	1
6A		COPPER WASHER	R-HG11FA	1
6B		BALL 1/4"	R-HG11FB	1
6C		CHECK VALVE SPRING	R-HG11FC	1
6D		CHECK VALVE SCREW	R-HG11FD	1
6E		CHECK VALVE SCREEN	R-HG11FE	1
7	XX	BY-PASS VALVE ASSEMBLY	R-HG11G	1
7A		BY-PASS VALVE STOP	R-HG11H	1
7B		CAP SCREW	R-HG11I	1
7C	X	BY-PASS VALVE O-RING - NITRILE	R-HG31	1
8		HYDRAULIC RELIEF VALVE	R-HG11J	1
8A	X	HYDRAULIC RELIEF O-RING	R-HG11K	1
9		FULCRUM ASSEMBLY	R-HG12	1
10		HANDLE	R-HG13	1
11		LINKAGE ASSEMBLY	R-HG14	1
11A		LINK	R-HG14A	2
11B		BOLTS	R-HG14B	3
11D		LOCK NUTS	R-HG14C	3
11E		FULCRUM LINK	R-HG14E	3

REF	KIT	DESCRIPTION	PART #	QTY.
12	XX	FLUID BAG	R-HG15	1
12A		FLUID BAG SEAL RING	R-HG15A	1
13		FLUID BAG BARREL	R-HG16	1
14		FLUID BAG BARREL CAP	R-HG17	1
		HYDRAULIC FLUID	R-HOPINT	1
		SET SCREW (OPTIONAL)	R-HG33	1
16		HANDLE LATCH ASSEMBLY	R-HG30	1
16A		STEM AND KNOB	R-HG30A	1
16B		LATCH SCREW	R-HG30B	1
16C		STEM SPRING	R-HG30C	1
16D		RETAINER	R-HG30D	1
16E		LATCH ARM	R-HG30E	1
16F		LATCH SPRING	R-HG30F	1
16G		LATCH SLEEVE	R-HG30G	1
16H		CAP SCREW	R-HG30H	1
17		18" HIGH-PRESSURE HOSE ASSY.	H-H-HOSE	1
17A		1/4" M x 1/4" M NIPPLE	H-AD-4M4M	1
17B		15,000 PSI GAUGE	H-GD-01C	1
17C		1/4" HIGH-PRESSURE TEE	H-T-444	1
17D		1/4" - 18 M x 1/4" - 27 M NIPPLE	H-AD-4M7M	1
17E		18" HIGH-PRESSURE HOSE	H-HS-18XHP	1
17F		STRAIGHT SWIVEL	H-SV-ST1	1
17G		GIANT BUTTONHEAD COUPLER	H-CPSG-2	1
X		O-RING REPAIR KIT	R-HGORER	
XX		MINOR REPAIR KIT	R-HGMIN	
XXX		MAJOR REPAIR KIT	R-HGMAJ	
		LATCH CONVERSION	R-HG-LC	1



## EZ-Loader

The Sealweld® **EZ-Loader** was designed to make loading cartridges quick and easy. Just pull back the T-handle, insert a cartridge, screw on the adapter and transfer the lubricant/ sealant into the high-pressure pump barrel. No waste, no mess and easy to store.

The use of cartridge type lubricant/sealants has been found to greatly reduce the risk of product contamination and trapped air in any pump.

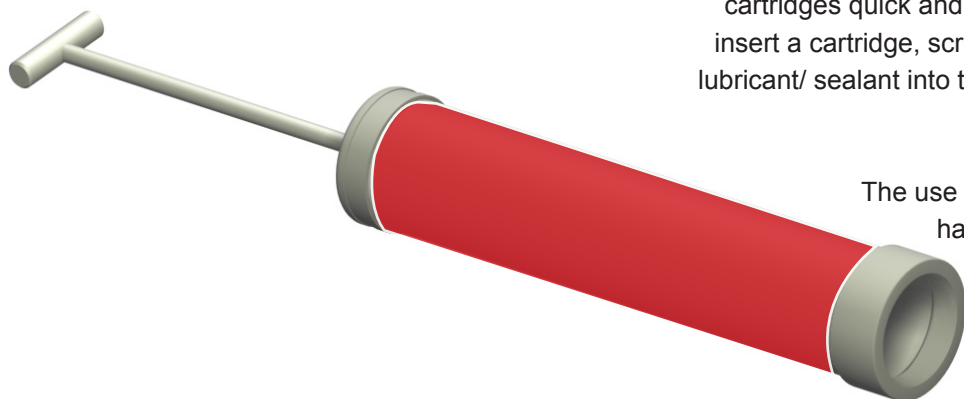

Order Details	
Description	Part No.
Fits Hydraulic Hand-Held, SuperGun, Uni-Seal™	G-EZ-LOADER
Fits Alemite 6268, Rockwell 400A	G-EZ-LOADER-AG

### EZ-LOADER Operating Instructions

1. Remove Gun from valve.
2. Relieve any internal gun pressure.
3. In case of:
  - A) Sealweld SuperGun - Remove head.
  - B) Sealweld Uni-Seal - Remove top cap.
  - C) Any Hydraulic Hand Gun - Remove top cap.
4. In all cases, Make sure piston or cups are at the top of the sealant barrel.
5. Remove EZ-LOADER adapter, then remove cap from sealant cartridge and place open end into EZ-LOADER.

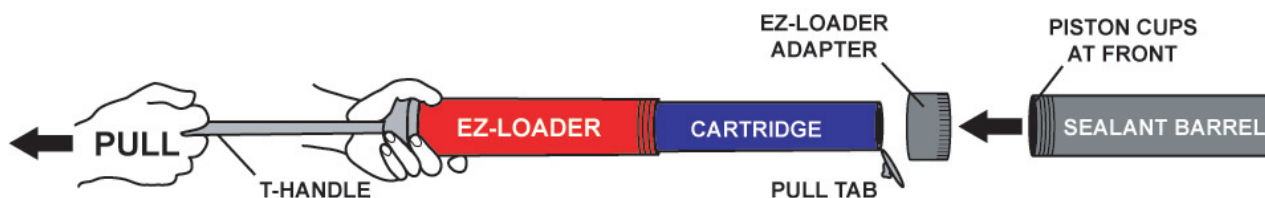

6. Pull until cartridge is completely inside EZ-LOADER with T-HANDLE as illustrated above.
7. When cartridge is completely inside EZ-LOADER, remove PULL TAB from cartridge and attach adapter.
8. Thread the EZ-LOADER assembly to the sealant barrel.
 

NOTE: Leave the threaded connection loose, as this will allow the air trapped between the sealant and piston cup to escape. Gently push the EZ-LOADER T-HANDLE forward until contact is made between sealant and piston cups; this forces the trapped air to escape through loose threads.
9. Tighten EZ-LOADER assembly to sealant barrel and follow the instructions on the following page.



## Auscillater™ Portable Valve Flushing Cart

Designed by one of the world's largest pipeline operators for the safe injection of flushing liquids into pressurized valves and vessels. Proven to flush out clogged riser pipes on large diameter buried valves, flush foreign debris from valve bodies and critical seal faces.

Proven effective – 2 years in development and 3 years in field service.

Flush contaminants from critical internal seals before and after pigging exercises to extend valve seal life.

Consisting of 8SFD-40 Liquid Pump with Arctic Modification Drive Assembly, fluid reservoir with fill port, air drive regulator, air drive filter, air drive gauge, speed control valve, return to tank valve, outlet regulator capable of 3 gpm at 2,000 PSI, relief valve to be downstream of outlet regulator and to drain back to tank, hydraulic accumulator suitable for diesel fuel, isolation valve for accumulator, and outlet pressure gauge all housed in a metal cart frame with gauges panel-mounted and wheels. Parts available on request.

24 gallon capacity tank.

Arctic-duty rated regulator to be (using Buna-C seals)



### Order Details

Description	Part No.
Portable Valve Flushing Cart	G-FGUN

**WE SELL VALVE CARE PRODUCTS. WE DELIVER PEACE OF MIND.**

## Cyclone Recovery Tank

Recommended for use when blowing down valve bodies in natural gas pipelines to capture liquids.

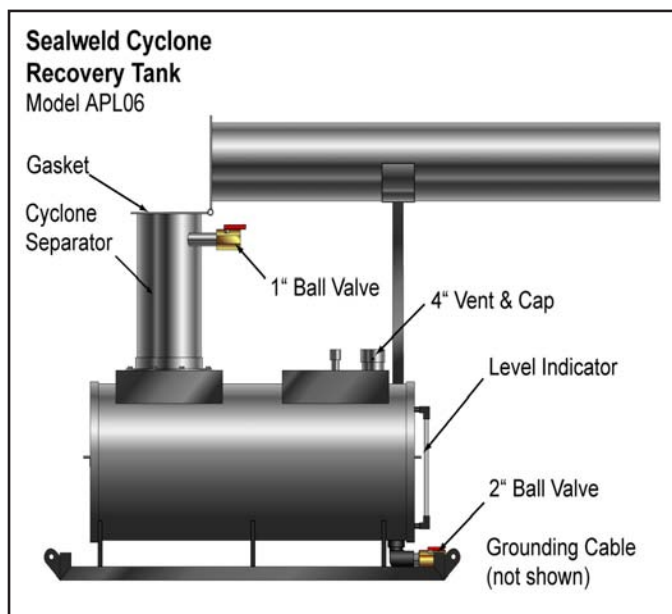

Use for normal valve servicing procedures. Connect cyclone via high-pressure hoses to the body vent or blow-down assembly. The cyclonic action will separate gas and liquids, the tank will collect the various liquids associated with the transportation of natural gas including gas liquids, water, condensate and compressor/ turbine oil. Take the oil to oil recycling depot and test for contamination. Recycle the clean oil and send contaminated product to the nearest hazardous waste disposal site.

The tank is **NOT** a pressure vessel, ALL gas pressure is vented to atmosphere through the 4" vent cap on top.

The **Sealweld® Cyclone Tank** comes complete as illustrated with all necessary piping, baffles and valves including sight glass/ level indicator.

The unit price includes black enamel painting.

Complete with 2 each:

1 inch 1D x 20 foot 2,000 PSI high-pressure hoses, forged steel unions and 2,000 PSI full-port shut-off valves.

Includes: 7 foot hinged stack extension, 2" drain valve, grounding cable.

### Order Details

Description	Part No.
Sealweld® Cyclone Tank Model APL06	W-CYC

 <b>Sealcoold</b> <small>COMPANION</small>	 <b>Techné</b> <sup>®</sup> <b>Valve &amp; Wellhead Components</b>	<h1>USE &amp; MAINTENANCE MANUAL</h1>		NR	MM-01/09
				REV	0

## GREASE FITTINGS

FITTINGS IN THIS GROUP ARE DESIGNED TO ALLOW INJECTION OF LUBRICATING/ SEALING GREASE INTO THE VALVES ON WHICH THEY ARE INSTALLED. THESE FITTINGS ARE DESIGNED TO PREVENT LEAKAGE TO ATMOSPHERE OF PRESSURIZED PIPELINE PRODUCT.

## BLEEDER FITTINGS

THESE FITTINGS ARE DESIGNED TO VENT PRESSURIZED PIPELINE PRODUCT FROM THE INSIDE OF THE VALVE ON WHICH THEY ARE INSTALLED. THESE FITTINGS ARE USED TO VERIFY THAT THE ASSOCIATED VALVE DOES NOT LEAK WHEN IT IS IN A PRESSURIZED CONDITION.

## INNER CHECK VALVES

THESE FITTINGS ARE NORMALLY INSTALLED UPSTREAM OF GREASE FITTINGS AS A SAFETY PRECAUTION IN CASE THE ASSOCIATED VALVE IS DAMAGED AND LEAKS INTERNALLY. THESE FITTINGS MUST BE DESIGNED TO ALLOW PASSAGE OF THE LUBRICATING/ SEALING GREASE WITHOUT CREATING A SIGNIFICANT INCREASE IN THE PUMPING PRESSURE REQUIRED TO PASS THE GREASE THROUGH THE FITTING.

## AUTOMATIC PRESSURE RELIEF VALVES

THESE FITTINGS ARE DESIGNED TO PROVIDE AUTOMATIC PRESSURE RELIEF OF THE PIPELINE PRODUCT CONTAINED WITHIN THE BODY CAVITY OF THE VALVE ON WHICH THEY ARE INSTALLED. THE FITTINGS ARE PRE-SET BY THE MANUFACTURER TO RELIEVE AT A PRESSURE IN ACCORDANCE WITH THE PRESSURE CLASS OF THE VALVE ON WHICH THEY ARE INSTALLED OR, AT A PRESSURE SPECIFIED BY THE END-USER.

## PLUGS & OTHER FITTINGS

THESE FITTINGS ARE NORMALLY USED FOR THE TEMPORARY CLOSURE OF OPENINGS IN PIPING AND VALVES, OR FOR THE CONNECTION OF OTHER COMPONENTS.

## PRESSURE RELIEF TOOLS

THESE TOOLS ARE DESIGNED TO ALLOW FOR THE SAFE RELEASE OF EXCESS PRESSURE INSIDE GREASE FITTINGS DURING MAINTENANCE OPERATIONS, OR DURING REPLACEMENT OF THE GREASE FITTINGS.

USING UNSUITABLE TOOLS MAY CAUSE DAMAGE TO THE INTERNAL COMPONENTS OF THE GREASE FITTINGS.

MATERIAL TEMPERATURE RANGE [°C]									
PRESSURE TEST	STEEL	T <sub>MAX</sub>	T <sub>MIN</sub>	CODE	GASKET SEAT	T <sub>MAX</sub>	T <sub>MIN</sub>	CODE	
	A105		+425	- 29	A				
	A350	LF 2	+400	-46	B	NITRILE	+100	-25	U
	A479	316L	+540	-196	C	HNBR	+150	-35	V
	A479	F53	+315	- 51	D	ERTALON	+150	-40	W
	A479	F51	+315	-29	E	PEEK	+200	-40	X
	A479	F55	+315	- 51	F	PTFE	+250	-50	Y
	B446	INC. 625	+980	-196	G	VESPEL SP1	+350	-196	Z
	DESIGNED UP TO MAX WORKING PRESSURE								
		HYDRAULIC		H	10 000 [PSI]		1		
		HYDRAULIC & PNEUMATIC		P	15 000 [PSI]		5		
					20 000 [PSI]		2		

THE DATA IN THIS TABLE IS INDICATIVE; FURTHER INFORMATION AVAILABLE ON REQUEST

## GREASE FITTINGS

## EDER FITTINGS

## CHECK VALVES

# AUTOMATIC PRESSURE RELIEF VALVES

## PLUGS & OTHER FITTINGS

PHASES				DESCRIPTION	WARNING
1	1	1	1	BEFORE INSTALLING THE COMPONENTS ON THE SYSTEM, REMOVE ALL OF THE PROTECTIVE SHIPPING MATERIALS (RED CAP, PLASTICS, ETC).	MAKE SURE THAT DIRT DOES NOT ENTER THE INSIDE OF THE BODY IN ORDER TO AVOID ANY DAMAGE TO THE SURFACES OF THE SEAT AND THE OBTURATOR.
2	2	2	2	BEFORE INSTALLING, PROTECT THE CONNECTING THREADS WITH AN ANTI-SEIZING MATERIAL TO AVOID DAMAGE.	AVOID EXCESS ANTI-SEIZE RESIDUE ENTERING THE FITTING BODY.
3	3	3	3	DURING THE INSTALLATION, BE SURE THAT THERE IS NO PRESENCE OF PRESSURE INSIDE THE EQUIPMENT.	THE INSTALLATION OF THE FITTING MUST NOT BE DONE BY HAND. IT IS NECESSARY TO INSTALL USING PROPER TOOLS.
4				BEFORE PROCEEDING WITH GREASING, IT IS NECESSARY TO REMOVE THE "VENT CAP".	REMOVE THE "VENT CAP" WITH CAUTION TO ALLOW ANY BUILT-UP PRESSURE TO ESCAPE.
		3		MAKE SURE THAT THE SET PRESSURE STAMPED ON THE VALVE BODY IS APPROPRIATE TO THE PRESSURE CONDITIONS OF THE OPERATION.	THE USE OF VALVES WITH UNSUITABLE PRESSURE RATINGS CAN CAUSE DAMAGE TO THE SYSTEM COMPONENTS AND FURTHER COMPLICATIONS.
5	5	5	5	IN CASE OF LEAKAGE, ABSOLUTELY AVOID OPERATIONAL CHANGES OR MODIFICATIONS TO VALVE COMPONENTS.	MAKE NOTE OF ANY NON-CONFORMANCE MATERIALS AND INFORM THE OPERATIONS PERSONNEL ASAP.
6	6	6	6	BEFORE UNINSTALLING THE PART, BE SURE THAT THERE IS NO PRESSURE INSIDE THE SYSTEM.	IT IS POSSIBLE THAT RESIDUAL PRESSURE IS INSIDE THE SPACE BETWEEN THE INNER CHECK FITTING AND THE GREASE FITTING. FOR THE SAFETY OF THE TECHNICIAN, IT IS NECESSARY TO ENSURE THE PRESSURE IS RELIEVED.
7				TO USE A "PRESSURE RELIEF TOOL," INSTALL OVER THE BUTTONHEAD FLANGE AND MANUALLY TURN THE HANDLE TO DEPRESS THE STINGER AND UNSEAT THE BALL CHECK.	MAKE SURE THE RELIEF TOOL IS COMPATIBLE WITH THE FITTING. USE OF AN INCOMPATIBLE TOOL COULD EASILY DAMAGE THE SURFACE OF THE FLANGE AND THE SEAT OF THE BODY MAKING THE COMPONENT UNUSABLE FOR FURTHER APPLICATIONS.
8	8	8	8	WHEN THE VALVE IS ASSEMBLED, PAY SPECIAL ATTENTION DURING THE PHASES OF TRANSPORTATION, INSTALLATION AND COMMISSIONING TO AVOID POSSIBLE DAMAGE TO THE FITTINGS.	POSSIBLE WEAR OR DAMAGE OF THE FITTING CAN CAUSE UNSAFE WORKING CONDITIONS. REPLACE ANY DAMAGED FITTINGS ASAP AND HOLD ANY NON-COMFORMANCE MATERIALS YOU MAY FIND. INFORM OPERATIONS PERSONNEL OF SUCH PROBLEMS IMMEDIATELY.
9	9	9	9	PERIODICALLY CHECK THAT THE FITTINGS SHOW NO VISIBLE SIGNS OF WEAR OR DAMAGE.	

**WE REFUSE ANY RESPONSIBILITY FOR DAMAGES CAUSED BY INAPPROPRIATE USE AND MAINTENANCE OR UNAUTHORIZED MODIFICATIONS TO THEIR PRODUCTS BY THE FINAL USER**

PED 97/23EC	ATEX 94/9EC	  			DESIGN IN ACCORDANCE WITH STD API 6D 23RD Ed. REQUIREMENTS
CE 0035	CE 0035	CEN REGISTERED	API/OP 0502	TS 0012	

**TECHNE S.R.L.**  
/IA C.NA CALIFORNIA 59/61 22036 ERBA (COMO) - ITALIA -  
TEL: +39-031-641009 - Fax: +39-031-641491  
[WWW.TECHNEVALVES.COM](http://WWW.TECHNEVALVES.COM) - [TECHNE@TECHNEVALVES.COM](mailto:TECHNE@TECHNEVALVES.COM)



# Flow Wolf® Techne®

## Valve Fitting Buyers Guide

Sealweld® Corporation is proud to announce the latest advancement in valve fitting technology with the introduction of the new **Flow Wolf® – Techne®** Sealant Injection Fitting, now available from stock.

Designed to extend the in-service life of every type and make of valve through the safe in-line and under pressure injection of valve cleaner, synthetic valve lubricants and emergency sealing compounds.

The ONLY valve fitting design with a "Certificate of Authorization issued by ABSA" the Alberta Boilers Safety Association, includes a CRN Number to ensure full compliance of your valves that fall under ABSA jurisdiction. Other similar approvals in other jurisdictions are now in process, for more information contact Sealweld® Corporation.

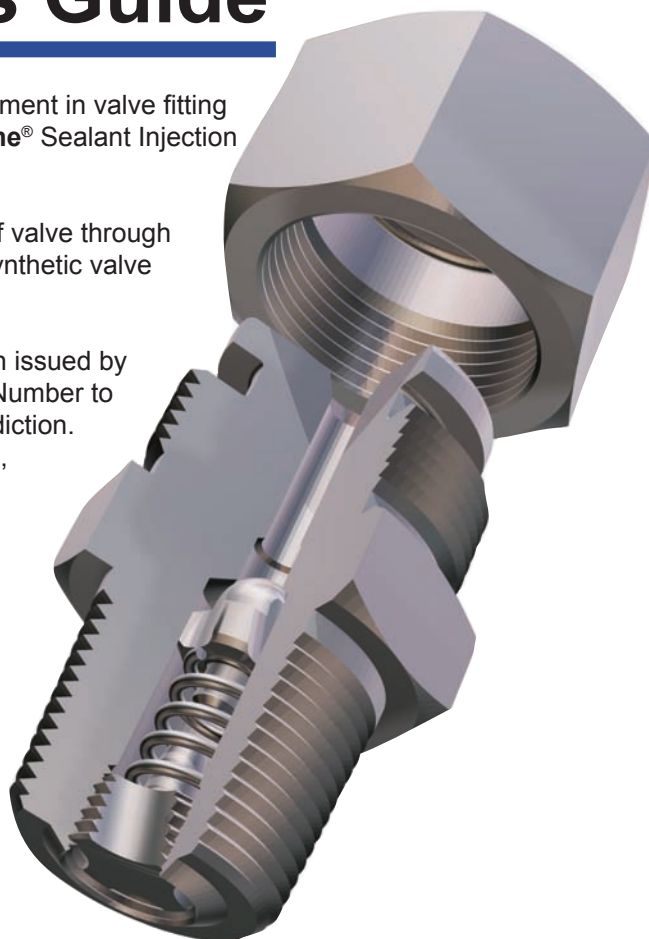

**Dangerous and sub-standard valve fitting designs are the #1 cause of valve technician injury and even death!**

### LOCAL SAFETY CODE

#### **ABSA**

##### **What is ABSA?**

ABSA (Alberta Boilers Safety Association) is the pressure equipment safety authority for Alberta. ABSA administers Alberta's pressure equipment safety program under the Safety Codes Act, and has the authority to enforce pressure equipment safety as set out in the legislation.

##### **Fittings Registration**

Any person who intends to manufacture a fitting for use in Alberta in connection with any boiler, pressure vessel or pressure piping system shall apply for registration of the fitting.

For the purposes of the Act and regulations, fitting means a valve, gauge, regulating and controlling device, flange, pipe fitting or any other appurtenance that is attached to or forms part of a boiler, pressure vessel or pressure piping system in a power plant, heating plant or pressure plant.

### Product Specifications

#### **VENTED STEEL CAP**

No-Leak Metal-to-Metal Seal  
Vents Trap Pressure for Safe Removal

#### **STANDARD PUMP CONNECTIONS**

Slip-On Style Giant Buttonhead Coupler  
Screw-On Style Threaded Coupler  
Screw-On Body Vent Tool to Un-Seat the Check Valve

#### **WRENCH FLAT IDENTIFICATION**

Traceable Heat Code  
Material Identification  
CRN Number

#### **CHOOSE YOUR THREAD TYPE**

NPT - Stock  
NPS - Special Order (Non-Stock)  
UNC - Special Order (Non-Stock)  
Metric - Special Order (Non-Stock)  
Other - Special Order (Non-Stock)





## Valve Fitting Buyer's Guide

### Features include:

- Patented One-Way Check Valve
- One-Piece Helical Obturator with Spring Compression Preventer
- Inconel 750 - Superior Strength and Corrosion Resistance. Elgiloy - upon request.
- Blow-Out Proof Helical Threaded Obturator Retainer with Spring Compression Prevention Cage

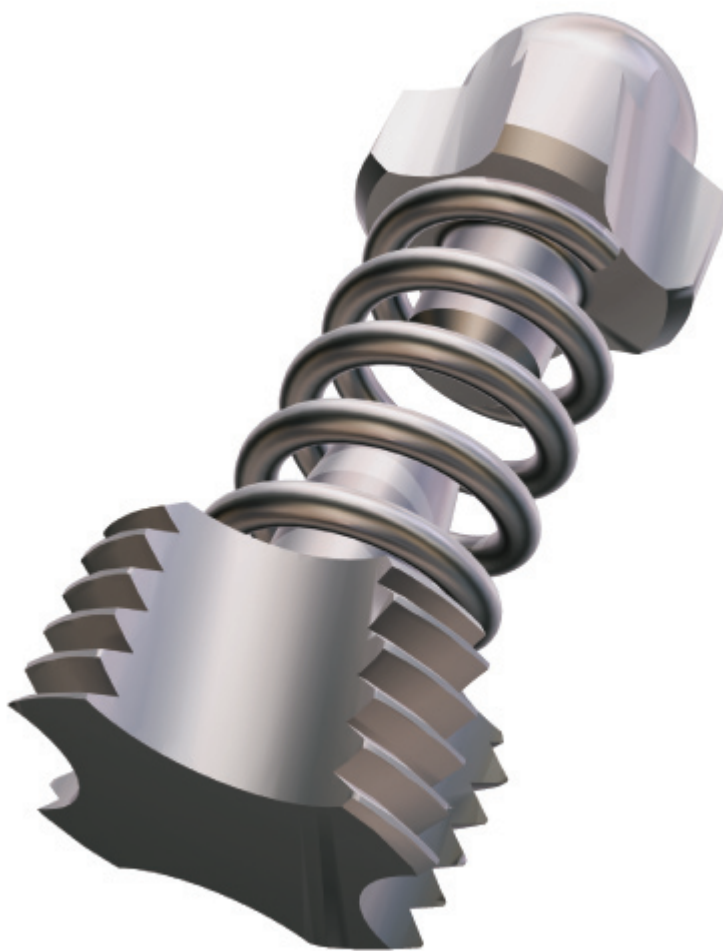

This ingenious new check valve design is patented in Italy with US and Canadian patents pending.

The entire line of Sealweld® Flow Wolf® Fittings, Internal Check Valves, Leak-Lock Adapters, the new Quad-Seal Fittings and Valve Fitting Adapters are now in the process of being converted over to the new Flow Wolf® – Techne® design.

Designed to be "leak-free" and able to pass the heaviest sealants through without plugging.



**Techne®**  
Valve & Wellhead Components

### SPECIFY: Flow Wolf® – Techne® Fitting

- For all your NEW VALVES
- UPGRADE your existing valve inventory
- Implement a Valve Fitting Replacement Program during your next scheduled outage

#### Product Specifications

##### VENTED STEEL CAP

- No-Leak Metal-to-Metal Seal
- Vents Trap Pressure for Safe Removal

##### STANDARD PUMP CONNECTIONS

- Slip-On Style Giant Buttonhead Coupler
- Screw-On Style Threaded Coupler
- Screw-On Body Vent Tool to Un-Seat the Check Valve

##### WRENCH FLAT IDENTIFICATION

- Traceable Heat Code
- Material Identification
- CRN Number

##### CHOOSE YOUR THREAD TYPE

- NPT - Stock
- NPS - Special Order (Non-Stock)
- UNC - Special Order (Non-Stock)
- Metric - Special Order (Non-Stock)
- Other - Special Order (Non-Stock)

#### Order Details

Description	Material	Part No.
1/4" - 18 NPT	Stainless Steel	F-FWT1/4-BH-SS-CRN
3/8" - 18 NPT	Stainless Steel	F-FWT3/8-BH-SS-CRN
1/2" - 14 NPT	Stainless Steel	F-FWT1/2-BH-SS-CRN
3/4" - 14 NPT	Stainless Steel	F-FWT3/4-BH-SS-CRN

#### Contact for Specialty Fitting Sizes

The helical cuts are designed to rotate / spin the orburator during grease injection thus providing a self-cleaning action to the sealing surfaces to enhance seal reliability and performance..

### DON'T TAKE CHANCES WITH:

- Valve Technician Safety
- Leakage Into The Environment
- Loss Of Production Revenues
- Unscheduled Down-time





## Setting New Standards

Many of the world's oldest and largest oil & gas fields have exceeded their original planned life expectancy and are seeing new expansions as new technologies are applied to increase production. This is in direct response to increased energy prices; fields that were once considered marginal are now being revitalized.

Sealweld® Corporation have been focused for nearly 40 years on developing products, technologies and procedures to extend the in-service life of large diameter valves in high-pressure pipeline applications. Now these technologies are being applied to valves on wellheads, gathering systems, processing facilities and gas distribution systems with equal success.



**Techne®**  
Valve & Wellhead Components

Sealweld® valve sealants are designed with the ability to achieve a reliable temporary seal in older worn valves. A valve technician's ability to inject an emergency sealant compound is determined by the quality and capability of the fittings installed on the valve. In an effort to manufacture a cheaper, less expensive valve, many valve manufacturers installed cheap and in some cases, dangerous fitting designs. Now operators are discovering that their ability to avoid a million dollar emergency shut-down is being determined by a \$5 fitting.

For decades, Sealweld® Corporation has been investing in research dedicated to understanding fitting failures. In collaboration with oil & gas producers and pipeline operators and through extensive cooperation with local and international regulatory and administrative bodies, we have designed new valve fittings capable of meeting or exceeding the demands of our rapidly expanding energy industry.

In direct response to increased industry demand for a solution to the problems with dangerous valve fitting designs, Sealweld® Corporation has formed a strategic alliance with Techne® S.R.I. to design and patent the solution; the new Flow Wolf® – Techne® fittings for valves.

**Flow Wolf® - Techne® fittings  
meet or exceed the following:**

### INTERNATIONALLY RECOGNIZED QUALITY STANDARDS & SPECIAL APPLICATIONS

PRESSURE VESSEL MARKINGS	
<b>ABSA</b>	Alberta Boilers Safety Association CRN 0C07140.2
<b>PED</b>	97/23/EC CE0035 Nr. 01 202 I / Ü-06 2320
<b>ATEX</b>	94/9/EC Nr. 968/Ex-Ab 871/06

QUALITY SYSTEM	
<b>ISO</b>	9001:2008 Nr. APIQR-0502
<b>ISO</b>	TS 29001 Nr. TS-0012
<b>API</b>	Q1 ED.8 Nr. Q1-0221

DESIGN IN ACCORDANCE WITH	
<b>API</b>	6D – 23rd ED.
<b>API</b>	6D SS I ED.
<b>API</b>	6A 19th ED.
<b>ASME</b>	VIII
<b>ASTM</b>	B16.34
<b>ARAMCO</b>	STD. 04/SAMSS-01 P35

PRESSURE TEST	
In accordance with internal procedures or upon request in accordance with API 598 or other stds.	

FUGITIVE EMISSION (UPON REQUEST)	
<b>ISO</b>	15848
<b>Shell</b>	SPE 77/312
* Additional qualifications available on request.	

**Dangerous and sub-standard valve  
fitting designs are the #1 cause of valve  
technician injury and even death.**



## New\* Flow Wolf® - Techne® Combination Fittings for Plug Valves

Also available in Flow Wolf® Style with Leak-Proof Steel Cap

### Flow Wolf® - Techne® Fitting Design

The patented **Flow Wolf® - Techne®** threaded-cage design has been incorp:

- Sealant injection fittings
- Body grease fittings
- Internal check valves
- Leak-Lock adapters
- Cameron®, WKM®, Daniel® and other specialty adapters
- Quad-Seal fittings and more!!

When servicing the plug valve with an injection pump, back the fitting out of the valve slightly. Inject sealant into the fitting and then disconnect.

If you need additional lubricant/ sealant injected and you do not have injection equipment with you simply screw the fitting further into the valve and the lubricant/ sealant will be injected as if you were using a packing injector.

Other thread configurations and materials available by special request.



Illustration only. Actual design may vary by model.

#### Flow Wolf® Patented Designs

Description	Part No.
Capped Buttonhead Fittings	F-FW # -BH
Capped Techne® Buttonhead Fitting	F-FWT
Quad-Seal Fitting Series	F-FWQS #
WKM® Screw-On Couplers	F-FW-SO #
Specialty Adapters for Cameron, WKM and Daniel Fittings	
Cameron® Screw-On Adapters	D-FW-CAM-SO-CS
Inner Check Design Series	D-FW-IC #
Leak-Lock Adapter Series	D-FW-LL #
Screw-On Buttonhead Adapter/Coupler	D-FW-SO-BH-CS

#### Other Thread Configurations

3/8" - 16 UNC
5/8" - 11 UNC
3/4" - 10 UNC
1/4" - 18 NPS
3/8" - 18 NPS
1/2" - 14 NPS
3/4" - 14 NPS
M24 x 1.5

**Sealweld® Flow Wolf® Techne® Sealant Injection Fittings have been granted a Certificate of Authorization issued by ABSA (Alberta Boilers Safety Association) and assigned the following Canadian Registration Number: CRN 0C07140.2**



## Patented 'Original' Flow Wolf® Fittings

The patented 'Original' Flow Wolf® threaded-cage design has been incorporated into all of our most popular fitting and adapter designs including:

- Sealant injection fittings
- Body grease fittings
- Internal check valves
- Leak-Lock adapters
- Cameron®, WKM®, Daniel® and other specialty adapters
- Quad-Seal fittings and more!!

### DESCRIPTION

The patented **Flow Wolf®** design was originally invented in the field by our founder, W.J. "Bill" Chisholm, on a job where we needed to inject a super heavy sealant compound into severely leaking valves.

The valve manufacturer's sealant fittings plugged off immediately and subsequent high-pressure resulted in the "blow-out" of the check valve mechanism.

This situation led to the development of the **Flow Wolf®** design with the assistance of Russian field engineers and the assistance Sealweld®'s own engineers in Canada. The **Flow Wolf®** design is now in use in pipeline valves around the globe and preferred by many of the world's largest pipeline operators. Also available by special request when you order new valves from all the world's leading valve manufacturers be sure to specify:

"Sealant fittings to be the Sealweld® **Flow Wolf®** design - no substitutes!"

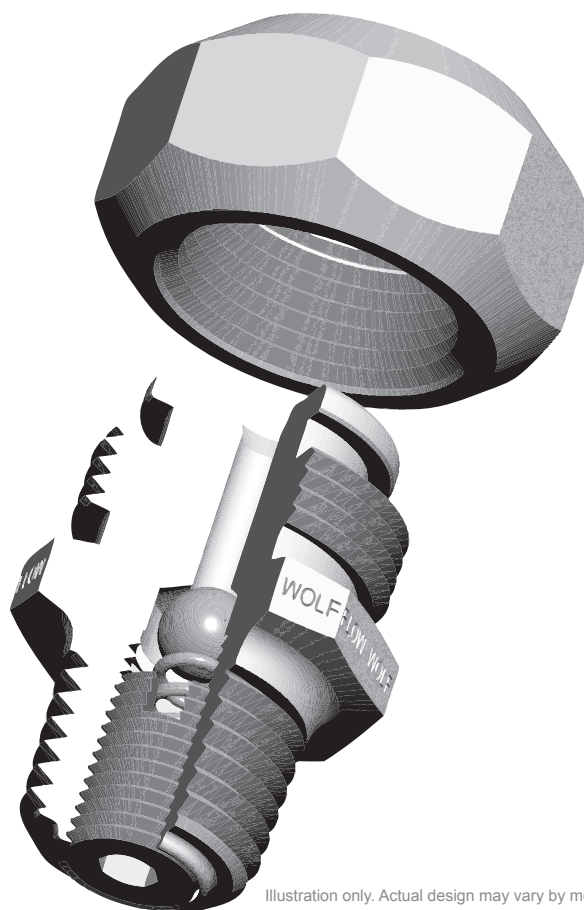

Flow Wolf® Patented Designs	
Description	Part No.
Capped Buttonhead Fittings	F-FW # -BH
Capped Techne® Buttonhead Fitting	F-FWT
Quad-Seal Fitting Series	F-FWQS #
Specialty Adapters for Cameron, WKM and Daniel Fittings	
Cameron® Screw-On Adapters	D-FW-CAM-SO-CS
Inner Check Design Series	D-FW-IC #
Leak-Lock Adapter Series	D-FW-LL #
Screw-On Buttonhead Adapter/Coupler	D-FW-SO-BH-CS

### Product Specifications

#### BUTTONHEAD FLANGE

For Giant Buttonhead Coupler

#### UNIQUE THREADED-CAGE DESIGN

Prevents check valve blow-out

#### "SAFETY VENT" CAP

With secondary metal-to-metal seal

#### "POSITIVE SEAL" THREADS

For screw-on coupler or valve bleed-down tool

#### REDUCES INJECTION PRESSURE

Up to 60%

#### ONE-PIECE BODY

Withstands more pressure than two-piece

#### "NO CRIMP" CAGE

Reduces the risk of metal fatigue

**Sealweld® 'Original' Flow Wolf® Sealant Injection Fittings have been granted a Certificate of Authorization issued by ABSA (Alberta Boilers Safety Association) and assigned the following Canadian Registration Number: CRN 0C07140.2**



## Patented Flow Wolf® - Techne® Quad Seal Fittings

Sealweld® is proud to introduce the latest advancement in sealant injection fitting design technology; the **Flow Wolf® - Techne® - Injection Fitting**

### DESCRIPTION

Eliminates all leakage to atmosphere and harmful fugitive emissions, during the maintenance routine and when the valve is unattended.

Ideal for use on offshore platforms, inside buildings, compressor buildings and meter stations, or when handling hazardous or toxic gases and/ or liquids.

All stainless steel construction eliminates the risk of plating failure, which can occur on all types of standard carbon steel. The thin plating is often worn off through use. The bare steel then begins to rust and corrode, rendering the fitting unusable and potentially dangerous.

Extend the effective service life of the fitting many times over. Reduce fitting replacement costs in all types of valves and wellhead equipment.

### Flow Wolf® - Techne® Fitting

Designed to be LEAK-FREE.

Allows the technician to safely remove the cap and attach the pump with ZERO RISK of product leakage to atmosphere. Open the upper section one full turn to open the metal-to-metal seal between the upper and lower sections. Then begin pumping. Close the metal-to-metal seal (one full turn) before detaching the pump. Replace steel cap to provide reliable double-isolation.

#### Recommended for:

**SEVERE service, including (but not limited to):**  
**H<sub>2</sub>S, CO<sub>2</sub>, NGL/ LPG, SAGD, steam,**  
**enclosed spaces, sub-sea applications...**

- \* Seal material specification is determined by intended service.
- Custom orders accepted.

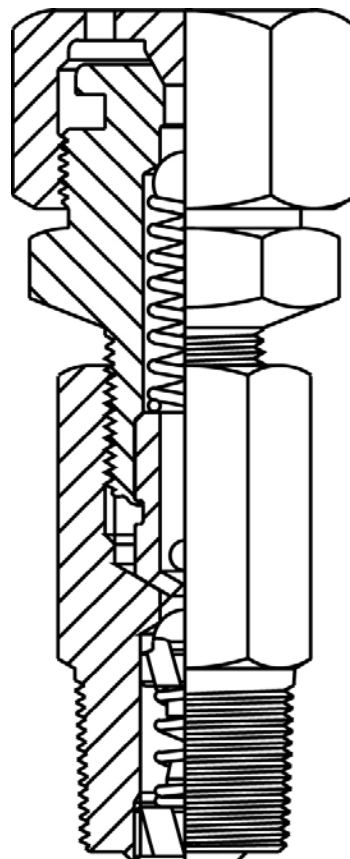

Thread	Material	Part Number
1/4" - 18 NPT	.316 Stainless Steel	F-FWQS1/4-SS
3/8" - 18 NPT	.316 Stainless Steel	F-FWQS3/8-SS
1/2" - 14 NPT	.316 Stainless Steel	F-FWQS1/2-SS

Product Specifications
.316 STAINLESS STEEL CONSTRUCTION For long life and superior corrosion resistance
4 INDEPENDENT METAL-TO-METAL SEALS For maximum seal reliability
2 DOUBLE-ISOLATION CHECK VALVES With verification capability
PATENTED FLOW WOLF® THREADED CAGE Allows heavy sealants to be injected in an emergency
2 COLLAPSE-PROOF SPRINGS Reduce injection pressures





## Flow Wolf® 1/4" Buttonhead Fitting

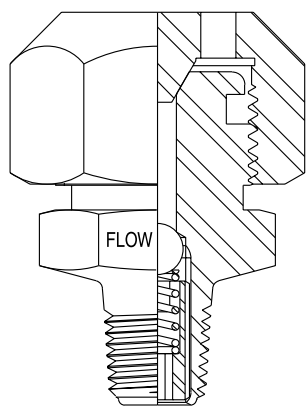

Thread	Material	Part Number
1/4" - 18 NPT	.316 Stainless Steel	F-FW1/4-BH-SS-CRN

The 1/4 inch **Flow Wolf**® vented cap, single check, sealant injection fitting with giant buttonhead, comes in stainless steel ONLY. The tapered thread ensures a tight fit. Perfect for small ball and gate valves.

Suitable for high-pressure service.

## Flow Wolf® 3/8" Buttonhead Fitting

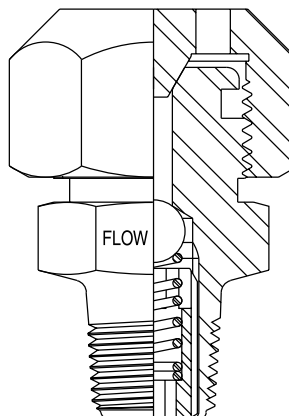

Thread	Material	Part Number
3/8" - 18 NPT	Stainless Steel	F-FW3/8-BH-SS-CRN
3/8" - 18 NPT	Carbon Steel	F-FW3/8-BH-CS

The 3/8 inch **Flow Wolf**® vented cap, single check, sealant injection fitting with giant buttonhead, comes in both stainless and carbon steel.

Suitable for high-pressure service.

## Flow Wolf® 1/2" Buttonhead Fitting

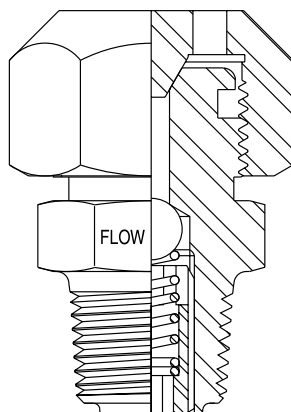

Thread	Material	Part Number
1/2" - 14 NPT	Stainless Steel	F-FW1/2-BH-SS-CRN
1/2" - 14 NPT	Carbon Steel	F-FW1/2-BH-CS

The 1/2 inch **Flow Wolf**® vented cap, single check, sealant injection fitting with giant buttonhead, comes in both stainless and carbon steel.

This fitting is the industry standard for ball valve fittings.

Suitable for high-pressure service.

## Flow Wolf® 1/2" Screw-On Fitting

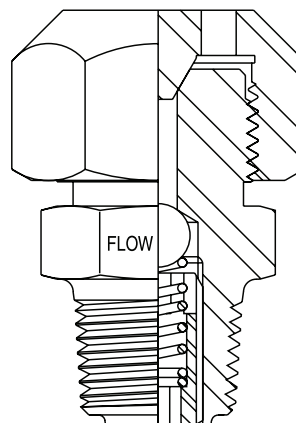

Thread	Material	Part Number
1/2" - 14 NPT	Stainless Steel	F-FW-SO1/2-SS-CRN
1/2" - 14 NPT	Carbon Steel	F-FW-SO1/2-CS

This 1/2 inch **Flow Wolf**® vented cap, single check, screw-on sealant injection fitting does not have a giant buttonhead connection. Most often used in wellhead gate valves or when using screw-on couplers.

Suitable for high-pressure service.



## Plug Valve Combination Fitting

### NH Fittings

Now available in **Flow Wolf®**

#### Features include:

- One-piece body
- Double-ball check
- Designed for use in plug valves
- Use as a plunger for injecting sealant sticks or simply attach to your pump using a side-entry or top-entry giant buttonhead coupler

Thread	Material	Part Number
3/8" - 16 UNC	Carbon Steel	F-NH3/8-CS
1/2" - 13 UNC	Carbon Steel	F-NH1/2-CS
5/8" - 11 UNC	Carbon Steel	F-NH5/8-CS
3/4" - 10 UNC	Carbon Steel	F-NH3/4-CS

Combination fittings can be used as a standard injection fitting when attached to an injection pump or can be used like a packing injector by simply screwing the fitting further into the valve.

Available in carbon steel ONLY. Stainless steel or other materials available by special request.

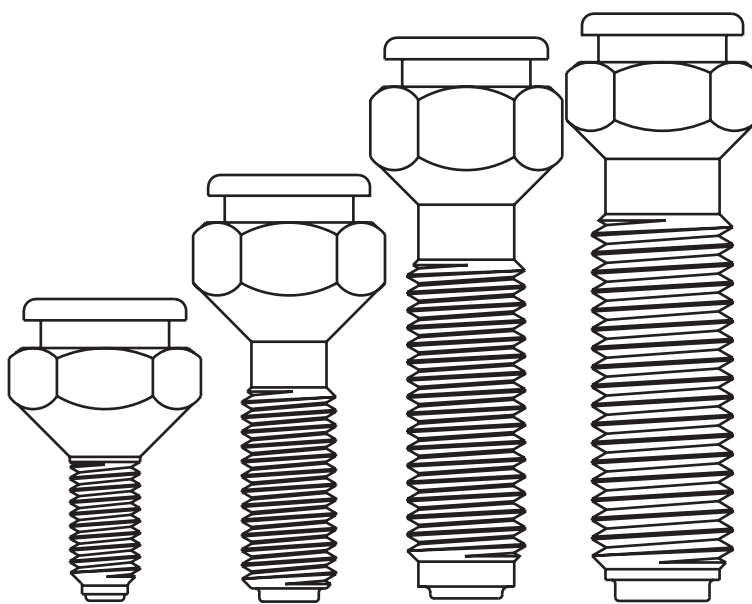

### RN Fittings

Now available in **Flow Wolf®**

Thread	Material	Part Number
1/4" - 18 NPS	Carbon Steel	F-RN1/4-CS
3/8" - 18 NPS	Carbon Steel	F-RN3/8-CS
1/2" - 14 NPS	Carbon Steel	F-RN1/2-CS
3/4" - 14 NPS	Carbon Steel	F-RN3/4-CS

When servicing the plug valve with an injection pump, back the fitting out of the valve slightly. Inject sealant into the fitting and then disconnect.

If you need additional lubricant/ sealant injected and you do not have injection equipment with you simply screw the fitting further into the valve and the lubricant/ sealant will be injected as if you were using a packing injector.

Available in carbon steel ONLY. Stainless steel or other materials available by special request.

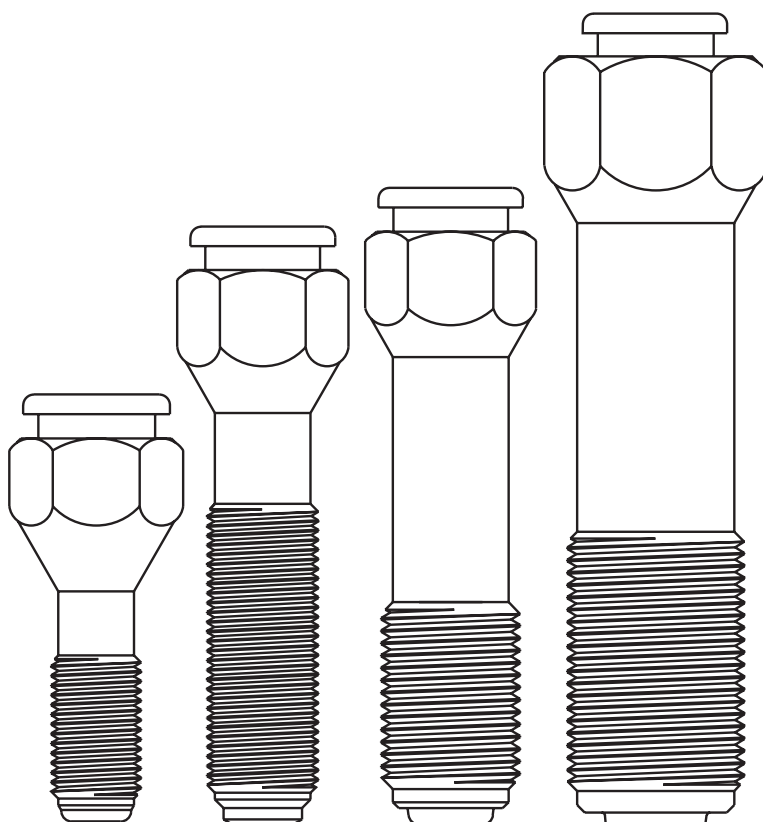



## Body Vent/ Drain Fittings

### Product Specifications

**WEATHER SEAL O-RING**

Prevents water from entering fitting.

**SPRING PINS**

Prevent removal of bolt.

**THREAD SEAL O-RING**

Prevents leakage through threads

**COARSE THREAD**

Prohibits thread damage

**THREADED VENT HOLE**

Pipe leakage away from work site

**REDUCED BORE HOLE**

Prevents jamming of ball

**.316 STAINLESS STEEL BODY**
**.316 STAINLESS STEEL BOLT**

Prevents corrosion, extend service life

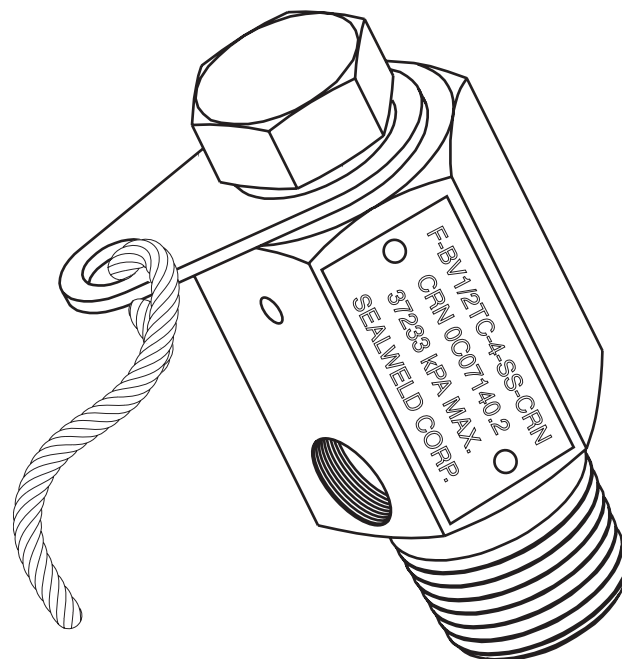
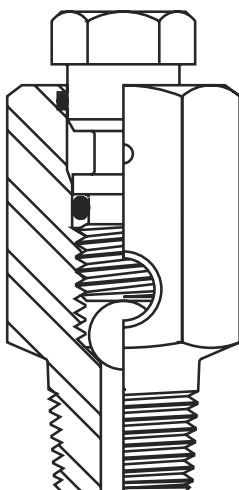

Thread	Material	Part Number
1/2" NPT	Stainless Steel	F-BV1/2-TC4-SS-CRN
3/4" NPT	Stainless Steel	F-BV3/4-TC4-SS
1" NPT	Stainless Steel	F-BV1-TC4-SS-CRN
1-1/2" NPT	Stainless Steel	F-BV11/2-TC4-SS

Similar to the TC3 in all respects with added stainless steel ring and cable. Designed to replace the existing carbon steel bleeder on hinged closures, where plating failure has rendered the existing fitting inoperable.

Available from stock in stainless steel ONLY. Other materials available by special request

Thread	Material	Part Number
1/2" NPT	Stainless Steel	F-BV1/2-TC3-SS-CRN
3/4" NPT	Stainless Steel	F-BV3/4-TC3-SS
1" NPT	Stainless Steel	F-BV1-TC3-SS-CRN
1-1/2" NPT	Stainless Steel	F-BV11/2-TC3-SS

The standard body vent/ drain fitting does not allow for the removal of the stinger which is held in place with pins. Ideal for blowing-down ball valves or releasing pressure from the body of a gate valve during normal service.

This fitting has a large opening to prevent freeze-up during depressurization.

Available from stock in stainless steel ONLY. Other materials available by special request.

### Disclaimer

Material selections suggested in this catalog are based on historical sales information ONLY. It is the responsibility of your engineering manager to make the final decision on the suitability of materials used for fittings on valves in your system. We have the capability to manufacture fittings out of various materials and grades. The carbon steel and stainless steel fittings referenced in this catalogue should work in most field conditions.

**Sealweld® Body Vent/ Drain Fittings have been granted a Certificate of Authorization issued by ABSA (Alberta Boilers Safety Association) and assigned the following Canadian Registration Number: CRN 0C07140.2**



## Giant Buttonhead Fitting

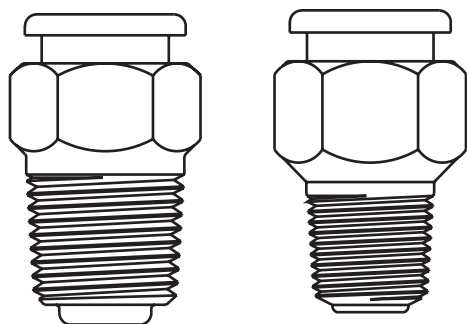

Thread	Material	Part Number
1/2" - 14 NPT	Stainless Steel	F-SW1/2-SS
3/8" - 18 NPT	Stainless Steel	F-SW3/8-SS
1/4" - 18 NPT	Stainless Steel	F-SW1/4-SS
1/8" - 27 NPT	Stainless Steel	F-SW1/8-SS*

One-piece body stainless steel buttonhead fittings are suitable for use in corrosive and most sour gas (H<sub>2</sub>S) services, or in exposed areas.

Larger sizes come with a double-ball check, the smallest size has a single-ball check.

\* Designates single ball check

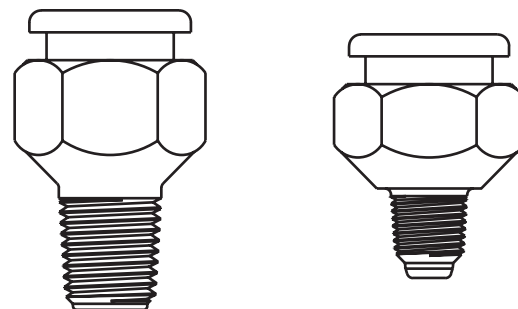

Thread	Material	Part Number
1/2" - 14 NPT	Carbon Steel	F-SW1/2-SS
3/8" - 18 NPT	Carbon Steel	F-SW3/8-SS
1/4" - 18 NPT	Carbon Steel	F-SW1/4-SS
1/8" - 27 NPT	Carbon Steel	F-SW1/8-SS

Standard one-piece body carbon steel buttonhead fittings are designed for use in enclosed, non-corrosive service areas.

Larger sizes come with a double-ball check, the smallest size has a single-ball check.

\* Designates single ball check

## Small Screw-On Adapter

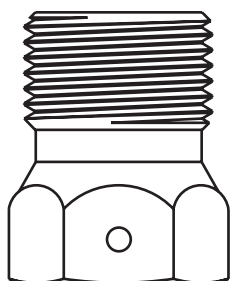

Material	Part Number
Carbon Steel	D-SSO-SO-CS

Screw-on adapter for small W-K-M/ IKS-type capped fittings.

Available in carbon steel ONLY. Stainless steel or other materials available by special request.

**A WIDE  
RANGE OF  
FITTINGS,  
ADAPTERS  
AND  
COUPLERS  
IN-STOCK  
NOW!**





## Internal Check Valves

BEFORE commissioning a new valve it is important to make sure it contains a top-quality internal check valve. When ordering a new valve, specify to the manufacturer that you want Sealweld® **Flow Wolf® Internal Check Valves**.

Sealweld® **Flow Wolf® Internal Check Valves** are ONLY manufactured from stainless steel and all include the patented **Flow Wolf®** threaded-cage to ensure that the ball check is NOT accidentally injected into the valve when pumping heavy valve sealant.

A working check valve is CRITICAL to ensuring valves can be serviced under pressure safely. Internal check valves will remain in place for years and must stand up to direct contact with corrosive environments. In addition, it is much more difficult to remove an internal check valve than a standard fitting, this is especially true when the internal check valve is corroded.

Ensure years of safe service by insisting on Sealweld® patented **Flow Wolf® Internal Check Valves**.

# FIT ALL NEW VALVES WITH FLOW WOLF® INNER CHECKS!

## Flow Wolf® 1/4" Internal Check Valve

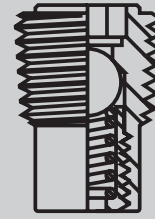

Thread	Material	Part Number
1/4" - 18 NPT	Stainless Steel	D-FW-IC1/4-SS-CRN

## Flow Wolf® 3/8" Internal Check Valve

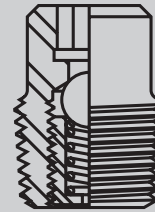

Thread	Material	Part Number
3/8" - 18 NPT	Stainless Steel	D-FW-IC3/8-SS-CRN

## Flow Wolf® 1/2" Internal Check Valve

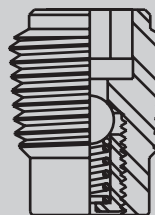

Thread	Material	Part Number
1/2" - 14 NPT	Stainless Steel	D-FW-IC1/2-SS-CRN

Sealweld® Flow Wolf® Internal Check Valves have been granted a Certificate of Authorization issued by ABSA (Alberta Boilers Safety Association) and assigned the following Canadian Registration Number: CRN 0C07140.2



## Flow Wolf® Leak-Lock Metal-Seat

### LEAK-LOCK ADAPTERS

#### Emergency Sealing Device for Buttonhead Fittings

Convert leaking or damaged fittings into safe fittings without shut-down or loss of production. Leak-Lock is not a permanent repair device but should be used until a scheduled turn-around or when the pipeline is depressurized and the leaking fitting can be replaced safely. Also for use on damaged buttonhead fittings.

The new **Flow Wolf® style Leak-Lock Adapter** has all the features of a regular Leak-Lock plus an additional metal-to-metal seal (with cap). Will accept liquids and pass the heaviest sealants without plugging off.

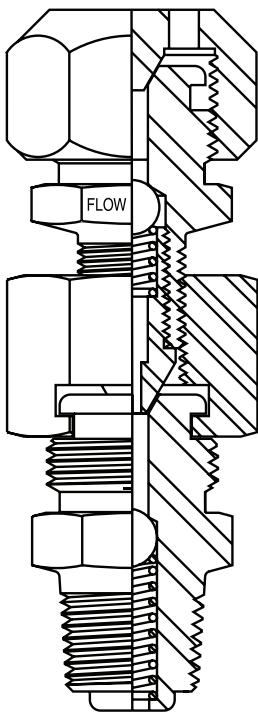

Material	Part Number
Stainless Steel	D-FW-LL1-MS-SS
Stainless Steel	D-FW-LL2-MS-SS

The **Flow Wolf® Leak-Lock #1** Metal-Seated Adapter is designed for use on capped fittings ONLY. It provides an additional check valve so you can continue to service the valve in-line, under pressure.

Can be used in applications where a second independent check valve is required to comply with safety codes or company policy. Can be left on permanently or until the pipeline is depressurized and the existing fitting can be replaced safely.

Seal type: Metal-to-Metal

## Flow Wolf® Leak-Lock Adapter #1

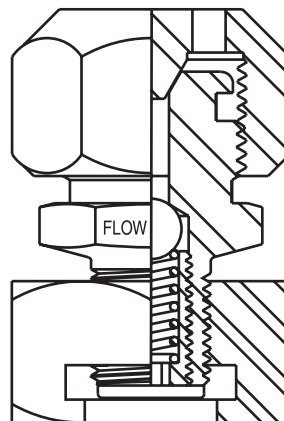

Material	Part Number
Stainless Steel	D-FW-LL1-SS
Leak-Lock Gasket	D-LL-GSK-ASB

This emergency sealing device fits on a leaking or damaged giant buttonhead fitting. Uses a replaceable gasket seal.

Ideal for old or leaking fittings or when you need to go from giant buttonhead to threaded coupler.

Seal type: Gasket

## Flow Wolf® Leak-Lock Adapter #2

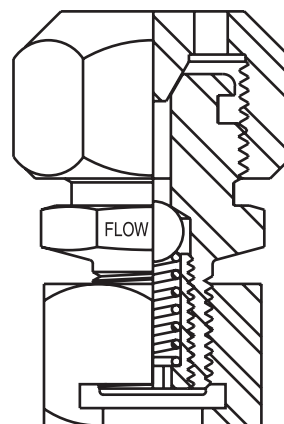

Material	Part Number
Stainless Steel	D-FW-LL2-SS
Leak-Lock Gasket	D-LL-GSK-ASB

This emergency sealing device converts a small buttonhead fitting to a giant buttonhead fitting.

Uses a replaceable gasket seal.

Seal type: Gasket



## Flow Wolf® Special Adapters

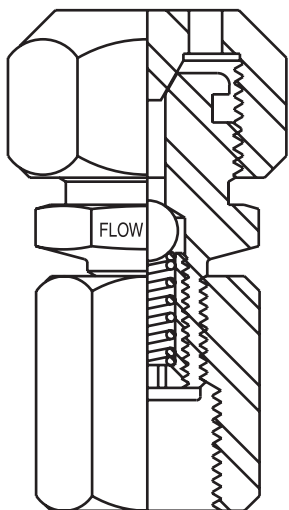

## Flow Wolf® Screw-On Adapter

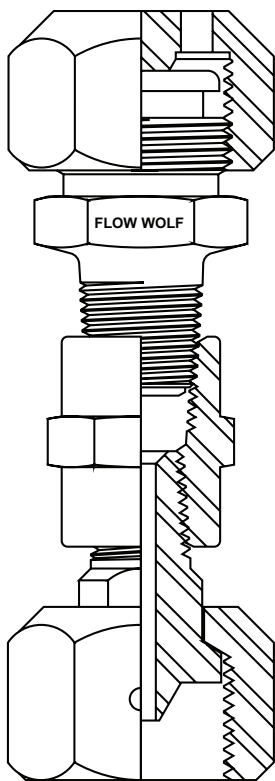

Material	Part Number
Carbon Steel	D-FW-SO-BH

This adapter goes from a standard screw-on fitting (body grease fitting) typically found on wellhead gate valves to a standard large buttonhead fitting. Allows you to quickly service a valve without changing the adapter on your injection equipment. Also extends the fitting length allowing you to get at those hard to reach fittings.

Available from stock in carbon steel ONLY. Stainless steel or other materials available by special request.

## Cameron Screw-On Adapter

Material	Part Number
Carbon Steel	D-FW-CAM-SO-CS

This adapter allows you to go from a small Cameron capped fitting thread connection to a standard giant buttonhead fitting or screw-on style. This adapter can be left on permanently to simplify servicing of Cameron valves.

Available from stock in carbon steel ONLY. Stainless steel or other materials available by special request.

## Daniel Orifice Fitting Adapter

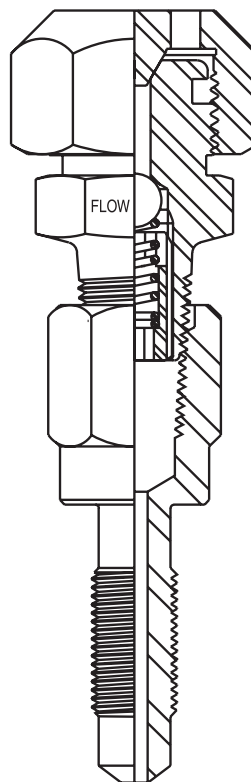

Material	Part Number
Stainless Steel	D-OA1/4-SS
Carbon Steel	D-FW-OA1/4-CS

This adapter allows you to service a Daniel Senior Orifice fitting as well as allowing you to inject sealant into a standard gate valve stem just like a packing injector.

This adapter is designed for Daniel Senior orifice fittings and allows the technician to inject **Valve Cleaner Plus** to clean the internal valve sealing surfaces. Can also be used to inject **Total-Lube #911** or **#5050** sealant in an emergency.

Also fits into packing injectors for **Valve Cleaner Plus** or sealant injection.

Available from stock in carbon steel and stainless steel. Other materials and grades available by special request.



## Screw-On Relief Valve Coupler

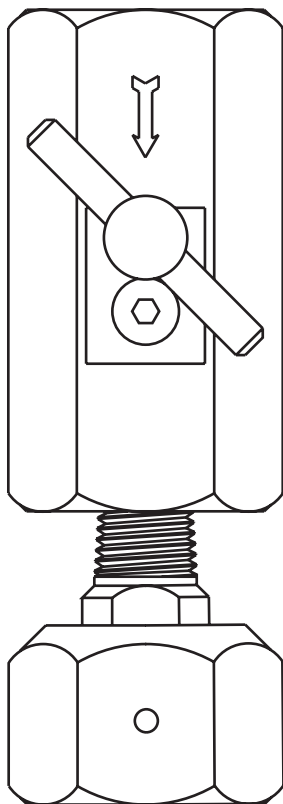

Material	Part Number
Carbon Steel	D-SO-RV

This handy screw-on style coupler includes a built-in needle valve for isolating the hose assembly from a leaking check valve in the body grease fitting. Commonly used for wellhead valve maintenance.

This screw-on coupler combines a one-way check valve and a release tool.

Ideal for servicing wellhead gate valves, quickly and easily.

In the event that an old or inferior fitting fails during service the coupler can safely be left on until the next scheduled shut-down. Keep a few extra couplers in your kit for this reason.

Available in carbon steel ONLY. Stainless steel or other materials available by special request.

## Sealweld® Screw-On Body Vent Tool

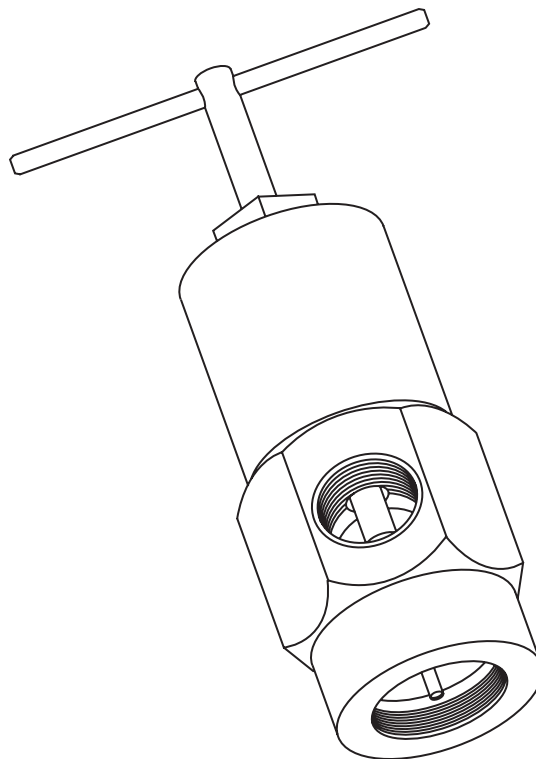

Material	Part Number
Carbon Steel	D-SO-BV-CS

This tool is specifically designed to allow you to un-seat the ball check in body grease fittings and sealant injection fittings.

A MUST when servicing many types of wellhead gate valves.

Also ideal for equalizing pressure when servicing wellhead gate valves.

Available in carbon steel ONLY.





## Giant Buttonhead Coupler

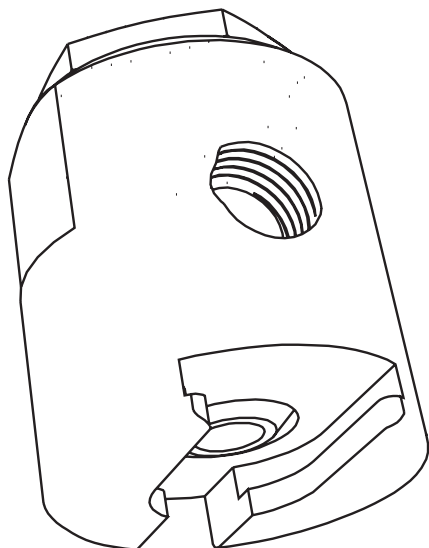

Material	Part Number
Carbon Steel	H-CPSG-2

The Sealweld® giant buttonhead side-entry coupler allows you to quickly attach on to standard giant buttonhead fittings for fast service.

Features - metal button with spring.

Available in carbon steel ONLY

## Top-Entry Buttonhead Coupler

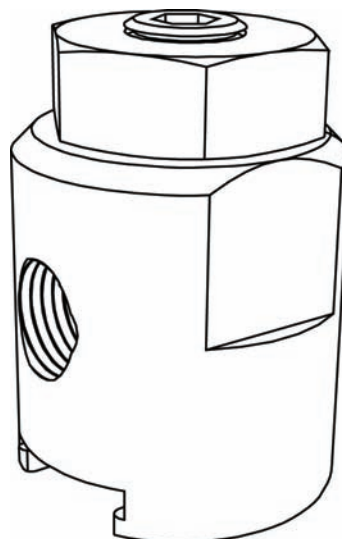

Material	Part Number
Carbon Steel	H-CPSG-3

The top-entry buttonhead coupler allows you to easily gain entry to buried or confined valves.

Features - metal button with spring.

Available in carbon steel ONLY.

## Sealweld® Screw-On Coupler

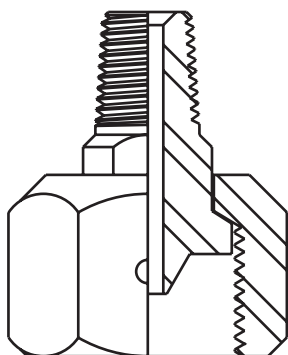

Material	Part Number
Carbon Steel	H-CPSO

This screw-on coupler provides a tight metal-to-metal seal.

Ideal for injecting heavy sealant or when working in high-pressure or sour service.

Available in carbon steel ONLY.

**STAINLESS STEEL  
OR OTHER  
MATERIALS  
AVAILABLE BY  
SPECIAL  
REQUEST**



## Pressure Relief Tool

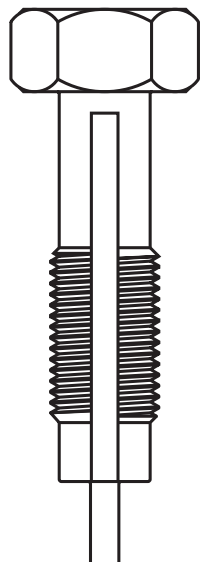

Material	Part Number
Carbon Steel	D-PI-RLF

Used to un-seat the ball check in packing injectors to relieve excess gland pressure.

Available from stock in carbon steel ONLY. Stainless steel or other materials available by special request.

## 1/4" Packing Injector

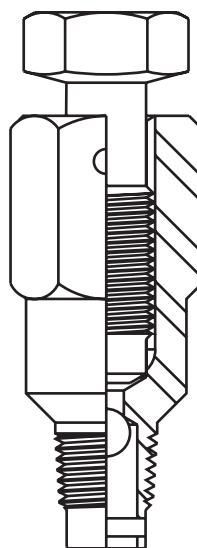

Material	Part Number
Stainless Steel	F-PI1/4-SS
Carbon Steel	F-PI1/4-CS

Available from stock in carbon steel and stainless steel. Other materials and grades available by special request.

## 3/8" Packing Injector

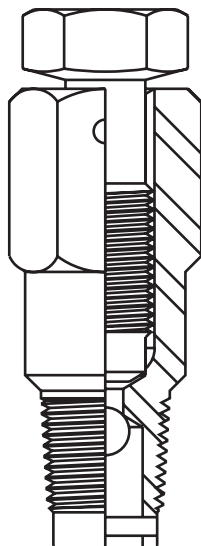

Material	Part Number
Stainless Steel	F-PI3/8-SS
Carbon Steel	F-PI3/8-CS

Available from stock in carbon steel and stainless steel. Other materials and grades available by special request.

## 1/2" Packing Injector

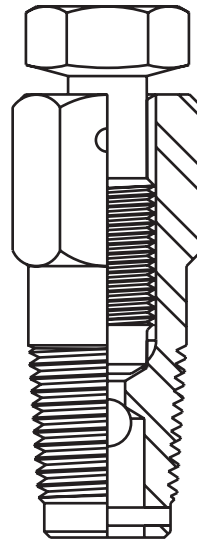

Material	Part Number
Stainless Steel	F-PI1/2-SS
Carbon Steel	F-PI1/2-CS

Available from stock in carbon steel and stainless steel. Other materials and grades available by special request.



### McEvoy-Style Fitting

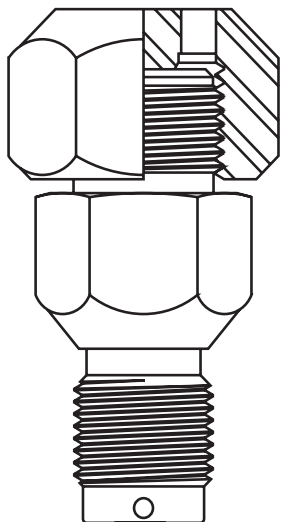

Thread	Material	Part Number
3/4" - 16 UNF	Carbon Steel	F-M1-CS

Body cavity fitting for a McEvoy valve. This fitting fits a McEvoy 7/8" – 14 UNS screw-on coupler thread.

Available from stock in carbon steel ONLY. Stainless steel or other materials available by special request.

### McEvoy-Style Screw-On Fitting

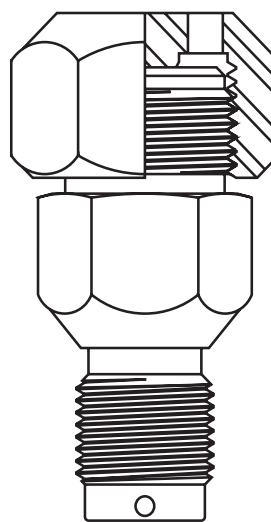

Thread	Material	Part Number
3/4" - 16 UNF	Carbon Steel	F-MSO-3-CS

Body cavity fitting for a McEvoy valve. This fitting fits a standard 1" – 14 UNS screw-on coupler thread.

Available from stock in carbon steel ONLY. Stainless steel or other materials available by special request.

### McEvoy-Style Giant Buttonhead

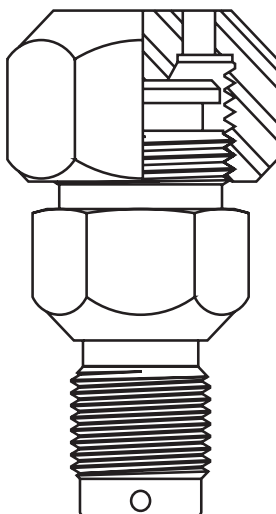

Thread	Material	Part Number
3/4" - 16 UNF	Carbon Steel	F-M2-CS

Sealant fitting for a McEvoy valve. This fitting fits a standard giant buttonhead fitting and screw-on coupler thread.

Available from stock in carbon steel ONLY. Stainless steel or other materials available by special request.

### McEvoy-Style Screw-On Adapter

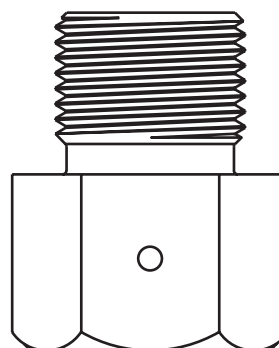

Thread	Material	Part Number
7/8" – 14 UNS	Carbon Steel	D-M1-SO-CS

This screw-on adapter converts from a McEvoy 7/8" screw-on coupler thread to a standard 1" – 14 UNS coupler thread.

Available from stock in carbon steel ONLY. Stainless steel or other materials available by special request.

## Sealweld® Flow Wolf® Valve Fitting Adapter Kit

A MUST for every valve technician. An assortment of our most popular adapters for attaching the hose assembly to the different styles of valve fittings.



### High-Pressure Gauge Assembly

ALWAYS use a high-pressure sealant injection pump with a high-pressure gauge attached. Keep ALL equipment in good working order and ready in case of an emergency. Complete with rubber guard to extend gauge life.



Order Details	
Description	Part No.
High-Pressure Gauge - 15,000 PSI	H-GD-01
High-Pressure Gauge /w Guard - 15,000	H-GD-01C
High-Pressure Gauge - 2.5" - Guard ONLY	H-GD-2.5

D-FW-KIT-06 – Flow Wolf® Adapter Kit Includes	
Description	Part No.
Flow Wolf® Leak-Lock Adapter #1	D-FW-LL1-SS
Flow Wolf® Leak-Lock Adapter #2	D-FW-LL2-SS
Flow Wolf® Leak-Lock Adapter #1 Metal-Seated	D-FW-LL1-MS-SS
Screw-On Body Vent Tool	D-SO-BV-CS
Flow Wolf® Screw-On Adapter	D-FW-SO-BH
Daniel Orifice Adapter	D-FW-OA1/4-CS
Cameron Screw-On Adapter	D-FW-CAM-SO-CS
Small Buttonhead Coupler	H-CPAS
Sealweld® Screw-On Coupler	H-CPSO
Small Screw-On Adapter	D-SSO-SO-CS
McEvoy-Style Screw-On Adapter	D-M1-SO-CS
Screw-On Relief Valve Coupler	D-SO-RV
High-Pressure Straight Swivel	H-SV-ST1
Release Valve	H-RVAB
Giant Buttonhead Coupler	H-CPSG-2
Locking Plastic Case	B-CS-ADPKIT

### High-Pressure Hose Assemblies

ALWAYS use a high-pressure hose and high-pressure threaded connections.

Contact us for special order items.

Optional: High-Pressure Hoses	
Hose Length	Part No.
2.3 foot/ 28 inches	H-HS-28HP
2.3 foot/ 28 inches	H-HS-28HYD
3.5 foot/ 42 inches	H-HS-42HYD
10 foot/ 120 inches	H-HS-120HP
12 foot/ 144 inches	H-HS-144HP
20 foot/ 240 inches	H-HS-240HP
25 foot/ 300 inches	H-HS-300HP
35 foot/ 420 inches	H-HS-420HP
50 foot/ 600 inches	H-HS-600HP
75 foot/ 900 inches	H-HS-900HP

Optional: Extra High-Pressure Hoses	
Hose Length	Part No.
1.5 foot/ 18 inches	H-HS-18XHP
2.3 foot/ 28 inches	H-HS-28XHP
3 foot/ 36 inches	H-HS-36XHP
4 foot/ 48 inches	H-HS-48XHP
5 foot/ 60 inches	H-HS-60XHP
6 foot/ 72 inches	H-HS-72XHP
10 foot/ 120 inches	H-HS-120XHP
15 foot/ 180 inches	H-HS-180XHP
20 foot/ 240 inches	H-HS-240XHP
30 foot/ 360 inches	H-HS-360XHP



## Sealweld® Service Procedures Library

### Technical Papers

Since 1969, the founders, stakeholders and most experienced employees have written a vast collection of case studies, informative articles and technical papers. Our most recent and most popular resources are listed below and can be downloaded from [www.sealweld.com](http://www.sealweld.com)

For copies of past papers, translated articles and copies of our reference letters contact Sealweld® by phone, fax, or email.

### CDs/ DVDs/ Video Cassettes

Order Details	
Description	Part No.
Valve Maintenance Handbook - Published	A-M-HB
The Digital Handbook on CD-ROM	O-CD-DHB
School Seminar Training on CD-ROM	O-CD-SD
Valve Maintenance Video on DVD	O-DVD-VMV
Activ-8® Sealant Injection Pump - Video	O-VD-A8
Cameron Ball Valve Maintenance - Video	O-VD-CAM
Valve Maintenance Training Video 90-Minute Box Set	O-VD-VMB
Catalogue	A-C-CAT

### DESCRIPTION:

**Economic Benefits of Valve Commissioning During Pipeline Construction** by Dean Chisholm, was published in the September 2000 issue of the Pipeline & Gas Journal.

**Preventative Maintenance Treatment of Pipeline Ball Valves in Natural Gas Pipelines** is based on actual field experiences practicing preventative and emergency valve maintenance in Malaysia, Borneo, Canada and the USA. Written by Dean Chisholm. Published in a 3-article series in ValveWorld Magazine, August 1997.

**Proper Valve Maintenance** by W.J.Chisholm, was published in the July issue of the Pipeline & Gas Journal.

**Modifying Pipeline Engineering Standards for Sealant Injection Fittings in Pipeline Valves** by Dean Chisholm, written & illustrated in August 1994. Published in a 3-article series in ValveWorld Magazine. One of our most requested papers.

**Destructive Testing of Ball Valve Seals and Effective Sealing Procedures in High Pressure Natural Gas Pipelines** by Dean Chisholm, describes the testing methods and measured results conducted on Grove B4-C and B5 ball valves from 1992-1995. Published in a 3-article series in ValveWorld Magazine.

**ValveWorld Commissioning (Spanish Version)** by Dean Chisholm. Translated and published by ValveWorld Magazine.

This program teaches your personnel how to save money, stop fugitive emissions and prevent accidents. Safety and knowledge are emphasized. Specifically designed so students do not need significant computer skills, users can relax and enjoy the training process, as they are easily guided through the program.

**ValvePro®** computer-based training (CBT) is combined with classroom sessions. This will provide your staff with the certification they need to perform the job. All instructors are Certified Valve Integrity Professionals with extensive field experience who present information in practical terms

Through computer-based training and practical hands-on testing **ValvePro®** offers the most complete Valve Maintenance Technician Certification available. \*

\* go to [www.valvepro.com](http://www.valvepro.com)

### ValvePro®

### Valve Technician Training

Order Details	
Description	Part No.
ValvePro ver. 2.30 - CD only	O-CD-230
ValvePro ver. 2.30 Single User - Complete Student Pack	O-VP-230-C
ValvePro Student Pack - Evaluation	O-VP-230-E

### ValvePro® - Training That Works

**ValvePro®** is a comprehensive training and qualification program aimed at the people responsible for the servicing and maintenance of valves.

Here's what to expect from the ValvePro® training program:
Learn how to extend valve service life.
Develop a checklist of everything to be done to get your equipment properly serviced.
Perform a complete valve health check including before and after service leakage verification.
Demonstrate your qualification to comply with Occupational Health and Safety legislation.
Free a seized ball, gate or plug valve safely.
Seal stem and seat leakage from all makes and types of valves.
Safely inject cleaners, lubricants, sealant and emergency sealants into valves under pressure.
Avoid costly mistakes by ensuring workers have the skills they need.
Save time and frustration knowing the servicing is right the first time.
Troubleshoot inoperable lubrication equipment.

CONTACT SEALWELD FOR ADVICE, PROCEDURES, VALVE SPECIFIC INFORMATION

# Sealweld Services



## ROUTINE VALVE MAINTENANCE

- Annual / Routine Preventative Maintenance -  
Lubricated Ball, Plug & Gate Valves
- Actuator and Gearbox Maintenance
- Testing Seat Sealing Integrity



## IN-LINE & UNDER PRESSURE

## TROUBLE SHOOTING

- Emergency Valve Sealing
- Seized / Hard-to-Turn Valves
- Internal Seat Leakage
- Stem Leakage
- Orifice Fitting Leakage
- Body Leakage
- Flange Leakage
- Launcher/Receiver Leakage
- Actuators & Controls



## FOR A FULL LIST OF OTHER SPECIALTY PRODUCTS AND SERVICES

• WELLHEADS • GAS DISTRIBUTION • LARGE DIAMETER PIPELINES • SUB-SEA

## CONSULTATION

- Preventative Maintenance Planning
- Valve Maintenance Programs
- Fitting Inspection/Replacement
- Training
- Outage Planning
- Valve Site Surveys
- Valve Health Audits
- Documentation / Reporting
- Procurement Consultation
- Valve Manufacturer Audits

.....

## NEW VALVE / ACTUATOR COMMISSIONING

- Fitting Inspection
- Valve Seat Lubrication
- Seat Integrity Test - Inspect & Adjust Travel Limits
- Actuator Installation and Calibration

.....

## VALVE & ACTUATOR REPAIRS

- Stem Seal Change-Out
- Refurbishing Old & Worn Mechanical Parts
- Procurement and Installation of Replacement Parts & Seals

**HELP SAVE THE PLANET BY USING *Sealweld* PRODUCTS.  
LEARN HOW TO EARN VALUABLE GREENHOUSE GAS CREDITS!**

**PLEASE SEE OUR CATALOGUE OR VISIT [WWW.SEALWELD.COM](http://WWW.SEALWELD.COM)**

**• UNITED NATIONS APPROVED GAS CENTRE METHODOLOGIES • U.S. EPA STAR PROGRAM APPROVED  
ASK SEALWELD FOR MORE INFO**



# *Sealweld*<sup>®</sup> CORPORATION

**#106 - 4116 - 64th Ave., S.E.  
Calgary, Alberta, T2C 3B3 • Canada**

**Toll Free: 1•800•661•8465**

**Phone: 1•403•236•0043**

**Fax: 1•403•236•5487**

**email: [info@sealweld.com](mailto:info@sealweld.com)**



**CALL TO ORDER 1-800-661-8465**

**WWW.SEALWELD.COM**



